

THE
HURON COUNTY BRANCH
O.G.S.

Box 469
GODERICH ONT.
N7A 4C7

OFFICE COPY
DO NOT REMOVE

*Huron
Cemeteries*

6391

BRANDON BELGRAVE CEMETERY
CONCESSION 9, LOT 42
EAST WAWANOSH TWP., HURON CO.
ONTARIO

ISBN 1-55034-804-3

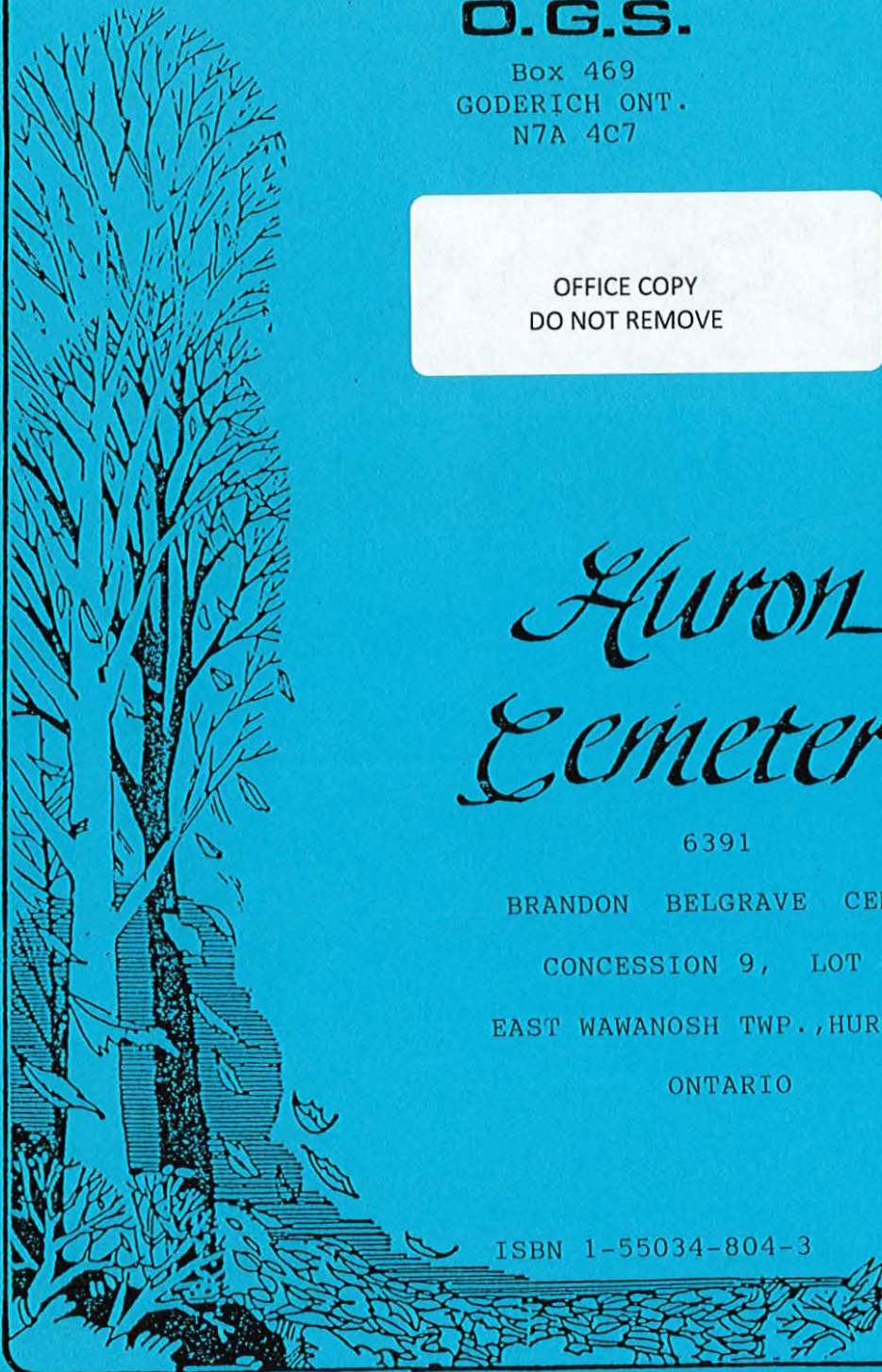

BRANDON CEMETERY

"In 1884 a group of interested parties held a meeting to arrange for the purchase of an acre of land from John Brandon at a price of \$25.00 to be used as a burying ground. It was known as Brandon Grave Yard but was later changed to the name of Brandon Cemetery."

This is a quote from the Centennial Book of East Wawanosh 1867-1967.

Four trustees were appointed at that time but later, in October 1928, the number was changed to 5.

The first four trustees were Wm. Hopper, Wm. Wray, Thomas S. Brandon and Matthew Brandon.

Apparently one of the first ways to raise money to finance the new venture was a "tea meeting". Matthew Brandon called on a Mrs. McKibbon to solicit subscriptions. She gave him \$5. but Mr. Brandon had not the \$2. change needed. So she received the money from proceeds from the tea meeting. This was Jan 1, 1885.

After appointing Mrs. Wray the first secretary/treasurer the motion was made that: "No plot of 8 x 12 feet shall be sold at a less price than three 'dollars'." Lots 8 x 12 were to be surveyed and marked out on the south side of the grave yard. A 4 foot walk was to be made on every side. Fifty blank deeds were to be purchased to supply those who bought a lot with a deed.

In March 1885 the secretary was to put up notices about the issuing of the deeds.

That year a lot cost \$3.; one half day's labour was worth .50¢; mowing grass for a half day was worth .60¢. By April 5, 1888 a notice was to be put up at the grave yard that all parties were to procure the deed of the lot before burial. They desired to hire a public grave digger. As well, a closed 'bord' fence was to be built in front of the grave yard. The yard was to be levelled and put in proper shape.

Matthew Brandon died before Dec 19, 1888 so George Daley was appointed to replace him.

In the S.E. corner of the cemetery a grave digger's house was built just after May 1908. It was to be of dressed, matched lumber, to be shingled and painted.

Wm. Wray died and was replaced by J.A. Brandon in July 1910. Brandon was to pay all orders of the Board of Trustees.

As a comparison of moneys handled, in 1906 receipts were \$52.50, expenditures \$6.25, balance \$46.25. Balance to date from other years \$42.94. So total balance was \$89.19. By May 1910 the total cash on hand was \$128.19, total expenditures \$57.15 so balance was \$71.04.

Sept 1922 with C.B. Wilkinson as chairman, W.C. Procter and Geo. Daley made a motion to purchase an additional acre from Percy Scardnett for \$200. The deal

braith who had been with the Wingham Cemetery since 1922 and who knew a great deal about Perpetual Care. As a result of this meeting, Perpetual Care was adopted.

New prices for 1943 were as follows: ¼ lot (2 graves) annual \$1., permanent \$20.; ½ lot (4 graves) annual \$1.50, permanent \$35.; 1 lot (8 graves) annual \$2., permanent \$50.; 2 lots (16 graves) annual \$2.50, permanent \$60. Annual notices were to be sent to grave holders. As of April 1944 Perpetual Care funds were to be invested in the 6th Victory Loan Bonds.

Secretary/treasurer received \$20. a year in 1945. A power mower was under discussion in 1947. More lots were surveyed in 1964 and by June 1966 the price of lots had risen to \$8. for a ¼ lot, \$15. for a ½ lot and \$25. for 1 lot.

For many years the meetings had begun with a visit to the cemetery where the tasks ahead were clearly seen. Many times loads of fill had been brought and the ground levelled and seeded. Fences were kept up and painted. In 1968 a work bee was held. This was one of several held in different years.

Ross Anderson was secretary/treasurer and in 1971 was made the official signer of cheques. He was to have access to a safety deposit box for documents. By 1982 the safety deposit box was discarded for a filing system.

The Dept. of Highways was first asked to blacktop the approach to the cemetery in 1965. In 1982 it purchased a strip of new and unused land beside the road.

The Cemetery Inspector appeared in 1976. He wanted the money from the Perpetual Care fund invested with the Public Trustee for Ontario. The two funds, general and Perpetual Care, were steadily increasing.

The subject of buying two more acres was brought up. Discussion arose again in 1977 as to whether to follow the Cemetery Inspector's request or not. Finally on Dec 16, 1980 it was decided to turn Brandon Cemetery Perpetual Care fund to the Public Trustee for investment. The Canadian Imperial Bank of Commerce, Wingham, was authorized to look after the transfer.

June 10, 1978 all bases of monuments were to be installed under supervision of the caretaker.

Buying 2 acres from Norm Cook was discussed in 1978. Severance of the 2 acres took place in Sept 1978 and on April 16, 1979 the sale agreement was made. Norman Cook was to receive \$3500. Any extra expenses in connection with the transaction were carried by the Cemetery Board.

A new deed form was drawn up in 1980 with deed and Perpetual Care receipt on the front and rules and regulations on the back. The Cemetery Inspector approved same. Since that time the rules and regulations have been put on separate sheets.

In addition to the trustees already named are the following: Herb Wheeler, Alex Porterfield, Wes Cook, Ken Wheeler, Garner Nicholson.

BRANDON CEMETERY CON.9, LOT 42. EAST WAWANOSH TOWNSHIP

1- Black	-----	Bell	- 3
20- Otto	-----	Goodfellow	- 4
21- Coultres	-----	McCallum	- 40
65- Wheeler	-----	Campbell	- 41
66- Nethery	-----	Miller	- 84
106- McCallum ⁿ	-----	Wightman	- 85
107- Scott	-----	Love	-117
139- McGuire	-----	Morton	-118
140- Naylor	-----	Campbell	-151
173- Higgins	-----	Whaley	-152
174- McGill	-----	Ferguson	-194
217- McBurney	-----	Stewart	-195
218- Cook	-----	Wilkinson	-228
255- Walsh	-----	Wheeler	-229
256- Noble	-----	Armstrong	-277
302- Lamont	-----	Anderson	-278
303- McSween	-----	Montgomery	-321

This cemetery was recorded in 1982 by Elain McKinnon, Alison Lobb, and Yvonne Porter, Lionel Gerry. It was typed and indexed by Yvonne Porter. The index was typed and checked by Jean Bircham. The history was done by Ruth Galbraith.

- 1 E. In memory of
G.HARVEY BLACK
1882 - 1950
his wife
LILA E.COOK
Jan.27,1889 --Feb.23,1937
W. BLACK
footstone MOTHER
- 2 E. WIGHTMAN
In loving memory of
MARY HOWATT
wife of CHARLES H.WIGHTMAN
1868 - 1934
CHARLES WIGHTMAN
1866 - 1942
son Pte.Charles IVAN
1894 - 1917
Buried at Passchendael
W. WIGHTMAN
- 3 E. BELL
In loving memory
JOHN T.BELL
1862 - 1939
his wife
JENNIE GARNISS
1873 - 1938
W. BELL
- 4 E. GEO.
GOODFELLOW
died
Apr.23,1897
Ae 60 Y'rs
Civility becomes everybody
- 5 E. SCOTT
JANE WALSH
1877 - 1936
Beloved wife of
DAVID S.SCOTT
1871 - 1963
- 6 E. S
DAVID SCOTT
died Apr.7,1909
aged 78 Yrs.
also his wife
ELIZABETH ELLIOT
died Feb.14 1911
in her 76th Yr.
SCOTT Brussels
W. S
4 cornerstones S
2 footstones FATHER MOTHER
- 8 E. WILLIAM
GRIGG
died
Nov.13,1904
aged
55 Y'rs
& 3 Mo's
Farewell my wife and children all
From you a father Christ doth cal
Mourn not for me it is in vain
To call me to your sight again
Wingham
- 8 E. In loving memory of
PHILIP MCKENZIE
died July 21,1915
in his 61st year
MCKENZIE
in loving memory of
PETER MCKENZIE
died Aug.19,1879
aged 72 Yrs
also his beloved wife
JANE
died June 12,1910
aged 81 Yrs
FINLAY MUNRO
died Oct.20,1880
aged 90 Yrs
- 9 E. FERGUSON
MARY E DALEY
wife of JOHN FERGUSON
died July 11,1914
aged 43 Yrs,5Mos,16 Dys.
JOHN J.FERGUSON
died Jan.14,1929/AGED 65 YRS.
Hersey Brussels
- 10 E. DALEY
MARY ANN WRAY
wife of
GEORGE DALEY
1851 - 1925
GEORGE DALEY
1847 - 1938
Brussels
- 11 E. CHARLES WILKINSON
1859 - 1902
his wife
MARGARET CLARKE
1863 - 1895
HARRY WILKINSON
1886 - 1921
Top WILKINSON

- 12 E.WALSH
JOSHUA I.WALSH
1855 - 1936
his wife
MARGARET BELL
1862 - 1947
W.WALSH
4 conerstones W
footstones
FATHER / MOTHER
- 13 E.HENRY
4 footstones
MAITLAND / ROBERT
EVALINE / MERLE
- 14 F.JAMES
son of
L.& D.HAYES
1930 - 1931
- 15 E.In loving memory
FREDERICK J.COOK
1884 - 1949
his wife
A.EDNA COOK
1891 - 1972
W.COOK
footstones
FATHER / MOTHER
- 16 E.in memory of
MARY E.COOK
1896 - 1956
wife of
JOHN S.BUCHANAN
1892 - 1970
W.BUCHANAN
- 17 E.COOK
In loving memory
GEORGE E.COOK
1892 - 1968
husband of
IVY M.COOK
1897 -
W.COOK
- 18 E.JAMES R.COULTES
1905 -
his wife
EDYTHE M.ARBUCKLE
1920 -
COULTES
W.COULTES
- 19 E.HENRY SCHAAF
1934 - 1975
Born in Germany
- 20 E.OTTO
husband
HEINRICH N
OTTO
1926 -
W.OTTO
wife
DOROTHEA
SCHAAF
1937 - 1980
The Lord Is My Shepherd
- 21 E.COULTES
ALBERT E.COULTES
1901 - 1977
his wife
FLORENCE M.SCOTT
1908 -
W.COULTES
- 22 E.ALBERT N.COULTES
1907 -
his wife
GRACE M.KERRY
1908 - 1974
COULTES
W.COULTES
- 23 E.GEDDES
In loving memory of
ERNEST / GEDDES
1882 - 1964
MARY / PORTERFIELD
1883 - 1971
2 footstones
MOTHER / FATHER
W.GEDDES
- 24 E.GEDDES
MARY I./GEDDES
1921 - 1974
STEWART P / GEDDES
A.LORRAINE /VARDON
W.GEDDES
- 25 E.GEDDES
M.CAMERON
1896 - 1972
ANNIE M.
1905 -
NORMAN M.
1893 - 1970
his wife/ISABELLA
1896 - /Ferguson

- 26 E. PROCTOR
ELVA M. BROOKS
1895 - 1956
mother
CHARLES ANDREW
1891 - 1959
father
W. PROCTOR
2 footstones
MOTHER / FATHER
small stone south of
large stone
P
- 27 E. In loving memory of
ROBERT COULTES
1878 - 1958
his wife
MARY TURVEY
1881 - 1949
2 footstones
FATHER / MOTHER
W. COULTES
- 28 E. In memory of
JEREMIAH BRYDGES
1856 - 1934
His wife ELIZA McCREA
1869 - 1944
daughter MARY ELLEN
1899 - 1927
3 footstones
MARY E / FATHER / MOTHER
W. BRYDGES
- 29 E. COLE
JOHN COLE
died Feb. 13, 1927
aged 77 years
his wife
ANN McKENZIE 1852 - 1932
footstone
FATHER
Brussels
- 30 E. MARY M. HARRISON
wife of
FREDERICK W. COOK
Feb. 1861 - May 1935
FREDERICK W. COOK
April 1857 - Feb. 1940
COOK
W. VIOLET BUCHANAN
1901 - 1973
wife of
STANLEY COOK
1891 - 1977
footstones / FATHER / MOTHER
- 31 E. WM. PROCTER
died
July 4, 1892
aged
78 Yrs. 10 Mo.
& 9 D's
- 32 E. P
GEORGE PROCTER
died Oct. 5, 1922
in his 77th Year
CATHERINE MILLER
wife of GEORGE PROCTER
died May 13, 1921
aged 64 years
No pains, no grief, no anxious fear
Can reach our loved one sleeping h
here
PROCTER
- 33 E. PROCTER
ROWLAND A.
son of GEORGE & CATHERINE
PROCTER
died / Aug. 11, 1888
aged / 11 months
- 34 E. ALICE BURCHILL
beloved wife of
ARCHIBALD / NICHOLSON
died / Dec. 8, 1902
aged / 51 Y's
Meet Me In Heaven
NICHOLSON
N. WILLIAM CHARLES / NICHOLSON
son of
A. & A. NICHOLSON
Died / Dec. 11, 1889
aged / 7 Mos & 3 D's
God Blest in an early death
And called the infant to himself
- 34A leaning on north side of stone
Erected / to
WILLIAM C.
son of
ARCHIBALD & ALICE / NICHOLSON
died / Dec. 18, 1889
aged / 7 Mos & 11 Dys
- 35 E. in memory of
MAGGIE / SWINDLEHURST
died / Nov. 16, 1906
33 Y's 8 Ms / 19 D's
Gone but not for/gotten

- 35 S. In memory
MARY A
wife of
ROBERT NICHOLSON
Feb.11,1891
aged / 78 Ys / 3 Mos.
- 36 E. JACKSON
WILLIAM/JACKSON
died/Aug.16 1906
aged/92 Yrs.10 Mo.
Native of Lancaster
- Shire England
He died as he lived
Trusting in God
S. Blessed are the
Pure in heart for
they shall see God.
- 37 E. Erected /in/memory/ of
ANNIE M
wife of
PETER W SCOTT
who died
Feb.25,1892,
aged/20 Years 3 Mo's
& 7 Days
only sleeping
W. PETER W.SCOTT
1866 - 1939
SCOTT
(s.m.)R.A.Bell,Goderich
- 38 E. JAMES A./ TASKER
died / Dec.23 1896
AE 30 Y'rs.9 Mo's & 11D's
HEAVEN is our Home
His wife MARY J.
CAMPBELL
died/Nov.5,1931
In her 62nd Year
TASKER
- 39 E. ANDERSON
JAMES ANDERSON
died July 28 1901
aged 65 Yrs.

His beloved wife
EUPHEMIA ARMOUR
died Dec.11,1906
Aged 66 Yrs.10 Mos.
Their daughter MARION
June 21,1872 Jan.24,1951

Their son JAMES D.
April 22,1878 Jan.22,1966
footstone MARION
- 40 E. In loving memory of
Lieut.JAS,McCALLUM
M.M. & Bar.France
Died of wounds Oct.5,1918
Aged 32 Yrs.
McCALLUM
JAMES McCALLUM
died Jan.22,1911
aged 80 Yrs.3 Mos.18 Days.
also his beloved wife
SARAH McLEAN
died Sept.14,1911
Aged 54 Yrs.8 Mos.25 Dys.
- 41 F. WIGHTMAN
- 42 E. Loving memory of
Sergt.C.A.CAMPBELL
161 Huron Battalion
Killed in action
France ___ 1918
aged 29 Yrs.
son of CHAS.
& A.J.CAMPBELL
CAMPBELL
(s.m)R.A.Spotton
- 42 N. JAMES C.WIGHTMAN
1899 - 1976
Husband of
J.VIOLA / CAMPBELL
1899
(s.m)R.A.Spotton
- 42 S. CHARLES / CAMPBELL
1856 - 1932
his wife
ANN JANE / BEECROFT
1858 - 1933
- 43 E. McDOWELL
MAUDE CAMPBELL
beloved wife of
HARVEY McDOWELL
died Feb.6,1912
aged 31 Yrs.6 Mos.
We may all meet there
HARVEY McDOWELL
died Oct.13,1913
Aged 32 Yrs.1 Mo.
- 44 E. McMURRAY
MARY YUILL
Beloved wife of
ROBERT McMURRAY
died Nov.15 1907
Aged 68 Yrs.
She died as she lived trusting
in God
ROBERT McMURRAY / Died June 1,
1925/aged 79 Yrs.9 Mos.

- 45 E. WILLIAM /CEASAR
died / April 25 1898
aged / 48 Yrs.
In deaths cold arms lies sleeping
here,
A tender husband, companion dear,
In love he lived, in peace he died
His life was asked, but was denied.
CEASAR
- 45 S. ISABELLA / McDOUGALL
wife of / W.CEASAR
died / Mar. 29, 1928
in her / 80th year
Asleep in Jesus
- 46 E. In memory of
THOMAS WM.
son of WM. & CAROLINE
GRIGG
died / Aug. 14, 1881
AE 2 Yr's & 8 Mos.
Farewell dear friends a longfarewell
For we shall meet no more
Till you's are raised with me to dwell
On Zions happy shore.
2 small stones in front
C.E. GRIGG / A.M. GRIGG
(s.m.) W. Smythe Wingham
- 46A In memory of
RUSSELL E. / GREGG
died / Nov. 18, 1896
AE 9 Ys. 7 Mos.
- 47 E. ALLISON
WALTER ALLISON
died May 28, 1888
aged 50 Years
his wife
ISABELLA McCALLUM
died Sep. 18, 1919
aged 78 years.
Peace Perfect Peace
- 47 W. ISABELLA ALLISON
1871 - 1937
SUSAN ALLISON
1883 - 1962
- 48 E. In memory of
SUSAN
dau. of
WALTER & ISABELLA
ALLISON
2 Mos & 5 Days
Brussels
- 49 E. PROCTER
ELLEN M. HOPPER
wife of
W.C. PROCTER
1864 - 1925
W. CHARLES PROCTER
1857 - 1926
WILLIAM W. died
April 29, 1888 AE 1 Yr.
MARY E died
Dec. 3, 1889 AE 7 Mos.
footstone / CARL
- 49 W. J. CARL PROCTER
1896 - 1970
his wife
HAZEL H. WILKINSON
1903 -
Infant son 1929
- 50 S. PROCTER
50 N. To The / Memory of
WLLM. J. PROCTER
Died / July 22, 1888
aged / 27 years / & 6 Mo's
Son of
ABR' M & MARY A. / PROCTER
A precious one from us has goi
A voice we loved is stilled;
A place is vacant in our home
Which never can be filled.
- 50 E. PROCTER
Rest In Peace
- 50 W. (s.m.) W. Wilson Goderich
- 51 E Father / ABRAHAM PROCTER
died July 26, 190(8)
aged 82 Years
In life beloved, in death lament
Also his wife
MARY A. BROWN RIDGE
Died Dec. 4, 1909
aged 83 Yrs. 7 Mos.
PROCTER
(s.m.) - & J. Wingham
- 52 E. ELIZABETH JOHNSTON
wife of
ARCHIBALD BRYDGES
1854 - 1925
son THO'S NOBLE
1889 - 1892
ARCHIBALD BRYDGES
1858 - 1947
BRYDGES

- 53 E. MARGARET D./MILLER
Beloved wife of
ROBERT GALLAGHER
Died/Dec.4,1903
Aged/41 Y'rs
GALLAGHER
N. ROBERT/LESLIE/MARY G.
Infant Children of
ROBERT & MARGARET
GALLAGHER
- 54 E. In memory of
WILLIAM JOHNSTON
June 24,1856 - Aug.21,1933
His wife ELIZABETH HUNTER
Oct.28,1855 - Feb.17,1939
JOHN FRANCIS SHOEBOTTOM
March 30,1885-Apr.18,1931
His wife
MARY JANE JOHNSTON
Nov.5,1880-Sept.8,1968
4 cornerstones
- 55 E. CATHARINE ROBERTSON
wife of
ADAM HALLIDAY
1844 - 1926
ADAM HALLIDAY
1833 - 1934
- 56 E. In memory of
ROBERT OWENS
1868 - 1927
His wife
MARY A.NETHERY
1875 - 1944
footstone /HUSBAND
W. OWENS
- 57 E. In memory of
CYRUS W.SCOTT
1877 - 1954
His wife
LIZZIE CUNNINGHAM
1878 - 1952
W. SCOTT
- 58 E. COOK
In loving memory
FREDERICK W. COOK
1882 - 1978
His wife
ETTA M.BLACK
1889 -
(s.m.)Wingham Memorials
Wingham
- 59 E. Inloving memory
HERBERT WHEELER
1881 - 1964
His wife
PEARL ANN PROCTER
1884 - 1978
W. WHEELER
- 60 E. FERGUSON / JAMES A.
1892 - 1972
DANIEL F.G.
1894 - 1979
- 61 E. In loving memory of
THOMAS COOK
1871 - 1965
- 62 E. IN loving memory of
JOHN STEWART ROGER
1889 - 1980
61 & 62 two small stones
on one base
- 63 E. COULTES
GEORGE F.COULTES
1881 - 1967
his wife
JENNIE LEAVER
1883 - 1969
At Rest
2 footstones
MOTHER / FATHER
- 64 E. Stone Cross
WHEELER
G.GOLDWIN
1911 - 1969
WINNIFRED M.
W. WHEELER
- 65 E. WHEELER
KENNETH WHEELER
Husband of
MABLE I.COULTES/
son IVAN 1949 - 1977
In loving memory
MAKAS
VINCENT MAKAS/
Husband of
MARY ANN WHEELER
1954 - 1976
W. WHEELER MAKAS

- 66 E. NETHERY
GORDON NETHERY
1920 -
His wife
GRACE YULE
1921 - 1978
- 67 E. PROCTER
ROBERT C. PROCTER
1911 - 1977
Beloved husband of
ELIZABETH SPEAKMAN
- 68 E. PROCTER
In loving memory
RICHARD W. PROCTER
1907 - 1963
His beloved wife
EDNA P. HENDERSON
1908 - 1969
W. PROCTER
- 69 E. In memory of
M. VERDA PROCTER
1906 - 1963
Wife of
G. WILBERT ARMSTRONG
1908 - 1967
W. ARMSTRONG
2 footstones
FATHER / MOTHER
- 70 E. PROCTER
A. HAROLD PROCTER
1902 - 1977
Beloved husband of
GRACE CURTIS
W. PROCTER
- 71 E. In memory of
ABRAHAM PROCTER
1866 - 1952
His wife
MARY A. STEWART
1868 - 1953
W. PROCTER
2 footstones
MOTHER / FATHER
- 72 E. PROCTER
In memory of
ELIZABETH M. NAYLOR
Nov. 30 1875 - Oct. 23 1944
wife of
WILLIAM J. PROCTER
Aug. 21 1879 - Sept. 23 1956
W. PROCTER
- 83 E. PROCTER
RICHARD PROCTER
April 1862 - Dec. 1927
His wife
MARGARET McMURRAY
Jan. 1876 - Sep. 1939
ELIZA PROCTER
Nov. 1864 - Aug. 1952
W. PROCTER
- 74 E. S
ELIZA J. PROCTER
Wife of
THOMAS SCANDRETT
Died March 5, 1923
Aged 66 Years
THOMAS SCANDRETT
Born April 4, 1856
Died Jan. 17, 1937
SCANDRETT
- 75 E. CHAMNEY
CARL BRUCE CHAMNEY
1911 - 1931
RICHARD CHAMNEY
1882 - 1956
Husband of
MINNIE BRUCE
1884 - 1970
- 76 N.F. ISABEL
Bel'd wife of
THOS WALSH
Who died
Feb. 1, 1892
AE 66 Years
By thy hand the boon was given
Thou hast taken but Thine own
Lord of earth and God of heaven
Evermore thy will be done
- SE. IN /Memory of
THOS. WALSH
Who died
Aug. 18, 1888
AE 61 years / & 11 Mos.
Jesus while our hearts are
bleeding
O'er the spoils that death has
done
We would at this solemn partin
Calmly say thy will be done
WALSH

77 E. DAVID JOHNSTON
1837 - 1898
His wife
MARTHA GRIGG
1936 - 1891
SARAH J.
1862 - 1898
SUSANNAH
1858 - 1909
JOHNSTON

78 E. In memory of
ALICE A. TYNDALL
Wife of
JOHN COULTES
Died Aug. 19, 1888
AE 32 Y'rs 1 Month

ALICE A.
Infant dau. of above
Died Dec. 8, 1888
AE 4 Mos.
In deaths cold arms lies
sleeping here, A tender
parent, A companion dear
In love she liv'd in peace
She died, Her life was
asked and was denied.
(s.m) W. Smyth Winham

S. ELLEN MILLER
Wife of
JOHN COULTES
Died June 3, 1909
AE 39 Yrs. 9 Ms.

JOHN COULTES
Died Sept. 6 1942
AE 83 Years

79 E. ANDERSON
FINLAY ANDERSON
1839 - 1932
JULIA ANN NAYLOR
Beloved wife of
FINLAY ANDERSON
1840 - 1922

Their dau. MARGARET M.
1871 - 1890

Infant dau. JULIA A. 1882
4 cornerstones A
3 footstones
MOTHER / JULIA A. / MARGARET M.

80 E. MARGARET / RENNIE
Wife of
JAMES / WIGHTMAN
Died/June 12, 1917
Aged / 89 Yrs. 2 Ms.
WHIGHTMAN

80 S. W
In/Memory of
JAMES WIGHTMAN
Died/Dec. 31, 1896
Aged/83 Yrs. 9 Mos./27 Dys.
Native of
Northumberland
England

N. W
In/Memory of
CATHERINE WIGHTMAN
Died/Nov. 8, 1900
Aged/35 Yrs. 5 Mos./8 Dys.

W. ISABELLA DOUGALL
1861 - 1938

81 E. In/Memory of
DORCAS LIDDIARD
Wife of
ROBERT McCORKINDALE
Who Died
Mar. 24, 1895
AE 66 Y'rs
Altho' Absent ever/near.
McCORKINDALE

S. At rest
ROBERT A. McCORKINDALE
Died/Mar. 23 1900
AE 75 Y'rs.
Native of
Glasgow Scotland
For him to die was/gain.

82 E. In memory of
JEMIMA
Wife of
JAMES GRIGG
Died/Sep. 28, 1899
AE 76 Y'rs
She looked for a city which
hath foundations, whos
builder and maker is God.
GRIGG

S. JAMES GRIGG
Died/Oct. 28, 1906
AE 79 Yrs./9 Mo. 8 Ds.
At Rest.

83 E. In memory of
ELEANOR ARMSTRONG
1868 - 1943
Wife of
JOHN McASH M.B.
1863 - 1949
JOHN A. 1899 - 1900
ELEANOR J. WARK
1896 - 1944

84 E. MILLER

In loving memory of
MILES MILLER
Died April 13 1908
Aged 86 Yrs.
His wife
ANN HOJSON
Died June 11, 1922
Aged 90 Yrs.

Native of Lancashire England

W. WILLIAM MILLER
1862 - 1951

85 E. B/MARGARET WIGHTMAN

Beloved wife of
THOMAS BLACK
Died Mar. 27, 1906
Aged 60 Yrs. 3 Mo. 27 Ds.
Gone but not forgotten.
THOMAS BLACK
Died Aug. 18, 1914
Aged 75 Yrs.
BLACK

86 E. W. FREDERICK

Son of
JOHN & FRANCES
BELL
Died/Nov. 24, 1903
Aged/26 Yrs. 5 Ms.

Gone gone loved one
gone to the tomb
But 'tis not cheerless
Hope dispels its alarm
While we are weeping
O'er the hallow'd ground
Thou art only sleeping
Till the trumpet sound
BELL

87 E. ELIZA/wife of
JAMES/COLDWELL
died/May 20, 1880
Aged 84 Yrs.

The Lord is my shepherd.
COLDWELL

88 loose stone against 89 N.

In memory of
JOSEPH E./son of
JOSEPH & MARY J.
STUBBS /Died
Nov. 17, 1872;

Aged 1 Mo. /& 17 Days
We loved this tender little one
And would have wished him stay
But let our Fathers will be done
He shines in endless day

89 E. JOSEPH/STUBBS

Died/May 18, 1903
In his 78 Y'R.
Died trusting in the Lord.
His wife
MARY JANE
Died/May 18, 1916
Aged 84 Yrs.

N. FRANCES E.

Dau. of
JOSEPH & MARY J./STUBBS
Died/Aug. 25, 1892.
AE 21 Y'rs/& 5 Mos.

Our loved one gone.

A light is from our household gone

A voice we loved is still

A place is vacant on our hearth

Which never can be filled

E. STUBBS

90 E. WRAY /WILLIAM WRAY

Died/July 23, 1910
Aged 67 Years.

In thee, O Lord, Do I put my trust

His wife SARAH E. CROWE
Died Sept. 30, 1924
Aged 84 Years.

91 E. At Rest/BENJAMIN WRAY.

Died Dec. 9, 1901:
Aged 86 Years.

ELIZABETH

Beloved wife of

BENJAMIN WRAY

Died Oct. 9, 1901

Aged 82 Years

More than conquerors at last

Here they find their sorrows o' WRAY

92 S. In/Memory of

ROBERT TAYLOR

Died/June 6, 1878;

Aged/41 Yr's & 3 M's

Native of/Perthshire
Scotland.

ELIZABETH/PATERSON

Died/May 30, 1903

Aged 64 Y'rs/& 5 Mos.

Safely anchored in the
harbor of eternal rest.

Dear is the spot where christian
sleep/How sweet the strains the
memory bare/Oh why should we in
silence weep/They are not dead
but gone before.

- 92 N. In/Memory of
ROBERT A.
Son of
ROBERT & ELIZABETH
TAYLOR
Died Feb.12 1890;
Aged/21 Yr's & 7 Mo's
A loving son,a brother dear
A faithfull friend when he
was here
Great is the loss we here
sustain
But hope in heaven to meet
again.
(s.m.)J.A.Robertson Goderich
TAYLOR
- 93 S. Mothers/grave
REBECCA JACOBS
Wife of
GERHARD/BRETZ
Died April 2,1888;
Aged 55 Yrs.& 3 Mos
Born in
Wayne County,N.Y.
BRETZ
E. BRETZ
N. 1888
(s.m.)White Bronze Co.
St.Thomas Ont.
- 94 NE JANE ANN/LAWLOR
Belov'd wife of
MATT BRANDON
Died/Oct.3,1921
In her 85th Y'r.
SE In/Memory of
MATTHEW/BRANDON
Died/Aug.23,1888
Aged/57 Years.
- 95 E. THOMAS /son of
GARET & ELLEN
MAXWELL
Died May 16,1875
AE 16 Y'rs 1 Mo.
ANNIE MAXWELL
Wife of
JAMES WILSON
Died Apr.26,1896
AE 29 Y'rs
Earth has no sorrows that
heaven/canot heal.
MAXWELL
- 95 S. JOHNSTON/MAXWELL
Died/June 10,1900
Aged/30 Y'rs 2 M's
There is no parting in
heaven.
ETHEL
Died/Oct.30,1902.
Aged 9 Yrs.
- 96 E. In Memory of
JOHN A.GEDDES
Born 1866 Died 1948
Beloved Husband of
ISABELLA FRASER
Born 1864 Died 1951
W. GEDDES
- 97 E. In Memory of
CORNELIUS G McCREA
1879 - 1960
Husband of
VERA O.BRADBURN
1886 - 1969
MARGARET M.1915 - 1930
W. McCREA /1 Cornerstone McC.
footstone/ MARGARET /FATHER
- 98 E. In loving memory of
JOSEPH A.BRANDON
Sept.20,1858 -- Dec.22,1937
His wife
DORA A.WRAY
Jan.6,1949
BRANDON
W. BRANDON
Cornerstones B
Footstones / HUSBAND
- 99 E. GEORGE W.PROCTER
1855 - 1927
His wife
ELLEN WILKINSON
1860 - 1946
EDITH E.PROCTER
1892 - 1958
PROCTER
3 footstones
FATHER /MOTHER/EDITH
- 100 E. In memory of
ROBERT J.SCOTT
1900 - 1946
His wife
MARGARET I.AITKEN
1895 - 1958

100 E. JOHN KENNETH SCOTT
1927 - 1979
His wife
LOTTIE MARGARET SAUNDERS
1931 -
W. SCOTT

101 E. KELLY
CLIFFORD A. KELLY
1929 - 1956
Beloved son of
WILLIAM & JEAN KELLY
WILLIAM KELLY
1886 - 1972
His wife
JEAN ANDERSON
1891
2 footstones/FATHER/CLIFF

102 E. PROCTER
In Memory of
J. STEWART PROCTER
1898 - 1972
Beloved Husband of
ALICE M. IMLAY
1901

103 E. WALSH
GORDON E. WALSH
1887 - 1971
His beloved wife
MARGARET M. SPEIR
1896 - 1973
W. WALSH

104 E. McCALLUM
In memory of
JOHN F. McCALLUM
1889 - 1973
His wife
ESTHER B. BRUCE
1896 -

105 E. McBURNEY
In loving memory
MARION W. WHITE
1922 - 1974
Wife of
J. ALLAN McBURNEY
W. McBURNEY

106 E. McCALLUM
In memory of
JOHN WENDELL
1929 - 1976

107 E. SCOTT
In loving memory of
MALCOLM R. SCOTT
1932
His beloved wife
FREDA G. HUNTER
1930
Their son DONALD M.
1958 - 1973
footstone DONALD

108 E. SCOTT
In loving memory
W. J. BORDON SCOTT
1911 - 1967
His wife
VIOLET M. WIGHTMAN
1910 -
W. SCOTT

footstone BUD

109 E. RINN
HARRY
1904 - 1965
His wife
MAY / 1919 -
footstone / FATHER

W. RINN

110 E. In memory of
EDITH M. BRUCE
1888 - 1962
Wife of
JOHN E. McCALLUM
1882 - 1978

W. McCALLUM

111 E. In memory of
JAMES LEITCH
1873 - 1952
His wife
LILY M. HENDERSON
1887 - 1966
JOHN A. 1915 - 1964
3 footstones/FATHER
MOTHER / JOHN A.

W. LEITCH

112 JOHN A. LEITCH
1915 - 1964

113 ROSETTA KINZIE
1870 - 1945
Wife of
LEVI GOOD SR. / 1866 - 1958

- 114 E. In memory of
ALEX PORTERFIELD
1877 - 1944
His wife
MAUD CODE
1878 - 1976
PORTERFIELD
W. PORTERFIELD
- 115 E. WIGHTMAN
MARION ISABEL SMITH
Wife of GEORGE D. WIGHTMAN
Died May 26, 1927
Aged 28 Yrs. 6 Mos.
GEORGE D. WIGHTMAN
1896 - 1966
DOUGLAS SMITH WIGHTMAN
Died June 1st 1927
Aged 5 Days
- 116 E. SCANDRETT
ROBERT PERCY SCANDRETT
1875 - 1923
His beloved wife
JULIA ANN ANDERSON
1884 - 1965
CORINE SCANDRETT
1907 - 1975/footstone/PERCY
- 117 E. In loving memory of
WILLIAM LOVE
1864 - 1930
His wife
MARY ELLEN VINT
1863 - 1935
LOVE
- 118 E. MORTON
In memory of
ALEXANDER MORTON
Nov. 1828 - May 1913
His wife
MARY McBURNEY
Aug. 1826 - Apr. 1909
- 119 E. In/Memory of
THOMAS WILKINSON,
Died June 17, 1900.
Aged 72 Yrs. 11 Mos. 17 Dys.
AT REST.
His wife
SUSAN NEWCOMBE
1825 - 1921
WILKINSON
- 120 E. In memory of
JAMES T. BRYDGES.
1872 - 1949
His wife
JEAN WHEELIENS
1876 - 1956
ARCHIBALD WM.
1900 - 1901
JERRIE
1913 - 1956
W. BRYDGES
- 121 E. In memory of
JAMES BRANDON
Died/April 1, 1890
Aged/82 Yrs & 4 M's
Precious in the sight of
the Lord is the death of
his saints.
BRANDON
N. ANN SHARP
Wife of
JAMES BRANDON
Died/Aug. 16 1903
Aged 85 Yrs
AT REST
(S.M.) A. J. Olowes Mitchell
NW. MARGARET J.
Dau. of JAMES & ANN
BRANDON /Died
Jan. 17 1909
Aged 68 Yrs
SW. In memory of
MATTHEW BRANDON
Died/November 23/1890
AE 41 Yr's
Blessed are the pure in heart
for they shall see God.
In memory of
ANNIE BRANDON
Died Feb. 5, 1900
AE 48 Y'rs.
122 E. In memory of
MARGARET/Beloved wife of
JAMES H BRANDON
Died/Aug. 28, 1885
AE 32 Y'rs/& 9 Dys
She made home/happy
A loving wife, a mother dear,
A faithfull friend while she
was here
She lived in hope, she died in
peace.
We trust her joys will never
cease
BRANDON

- 122 N. CLARK M./BRANDON
Died/June 20,1904
Aged/12 Yrs.6 Mo.
S. JAMES H./BRANDON
Died/July 21,1904
Aged/60 Yrs.3 Mo.
- 123 E. In memory of
HUGH MacLEAN
1856 - 1939
His wife
ELIZABETH JOYCE
1860 - 1945
MacLEAN
- 124 T. McLEAN
E. NETTY E.
Dau.of HUGH
& E McLEAN
1894 - 1917
S. ANNIE
1887 - 1889
COLIN H.
1889 - 1890
- 125 E. B /Wm.HENRY BRANDON
Died April.5,1927
Aged 75 Yrs.
MARJORIE S.BRYDGES
Wife of
W.H.BRANDON
1863 - 1921
BRANDON
S. MARGARET /SHARPE
1837 - 1927
- 126 E. In/Memory of
JAS BRANDON
Died/Oct.7,1878
AE 34 Yrs.
He's gone to live with saints
above
And rest in God's eternal love,

When she lived to God
There still did remain
He took her to his aboard
Where nought but Love remain
- N. In/Memory of
MARY /Wife of
JOHN P.BRANDON
Died July 26 1888
AE 64 Ys.
- 126 S. JOHN P./BRANDON
Died/June 28 1896
AE 96 Yrs.
Precious in the sight of
the Lord is the death of his
saints.
(s.m.) Smyth Bro. Wingham
- 127 E. ROBERT FORBES
His wife
MARGARET DARROGH
- 128 E. ROBERT JOHN FORBES
1848 - 1934
His wife
ELIZABETH A.MERNEY
1863 - 1934
Son THOMAS WILLIAM
Killed at Passchendael
Oct.26,1917
FORBES
- 129 E. NETHERY
In loving memory
J.COOPER NETHERY
1892 - 1967
W. NETHERY
- 130 E. N/In loving memory of
JOHN NETHERY
1845 - 1931
His wife
MARY E.HENDERSON
1861 - 1939
GEORGE E.
Born Jan.3,1894
Died June 16,1916
NETHERY
W. N /MARTHA J.
Born Feb.7,1885
Died Oct.20,1889
RUTH E.
Born May 31,1896
Died May 31,1898
Children of
John & Mary E.Nethery
- 131 E. In memory of
ROBERT J.YOUNG
1893 - 1931
His wife/EDNA MASON
1898 - 1956
Flt.Lt.ARCHIE YOUNG
1920 - 1945
Buried at Oslo Norway

131 E. AGNES 1918 - 1929

ELMER 1923 - 1971

W. YOUNG /footstone/FATHER/MOTHER

132 E. WHEELER

EDNA MAY SCANDRETT

Wife of

CECIL W. WHEELER

Died Aug. 28, 1929

In her 36th Year

LAURA M. ROBINSON

1893 - 1965

Wife of

CECIL W. WHEELER

W. WHEELER

133 E. In memory of

JOHN W. MASON

1871 - 1944

His wife

MARGARET E. NICOL

1867 - 1958

EDWIN J. MASON

1896 - 1955

W. MASON

134 E. In memory of

MARGARET YUILL

1880 - 1972

W. YUILL

135 E. In memory of

MABEL PROCTOR

1887 - 1952

Beloved wife of

JOSEPH YUILL

1883 - 1952

ROBERT G. YUILL

1913 - 1965

3 footstones

FATHER/MOTHER/ROBERT

W. YUILL

136 E. In loving memory

MYRTLE A YUILL

1918 - 1963

Beloved wife of

MIKE REZANSOFF

1915 - 1979

footstone

MOTHER

W. REZANSOFF

137 E. HEDLEY

In loving memory

MARY FERN NETHERY

1929 - 1966

Wife of

DAVID DENNIS HEDLEY

W. HEDLEY

She is made one with nature

There is heard her voice in all

Her music from the moan of

Thunder to the song of

Nights sweet bird.

She is a presence to be felt an

Known in darkness and in light

From herb and stone she is

A portion of the loveliness

Which once she made more lovely

138 E. JORDAN

In memory of

GEORGE A. JORDAN

1888 - 1971

Husband of

MABEL M. WALSH

1890 -

139 E. McGUIRE

In loving memory of

Father

HARRY L. McGUIRE

1894 - 1978

Mother

CARRIE M. STONEHOUSE

1899

140 E. FOUNTAIN NAYLOR

Died Dec. 10, 1900

Aged 56 Yrs.

His wife

ANN TAYLOR

Died May 2, 1914

Aged 68 Yrs.

BABY BELL

Infant son of

C. & A. BELL.

141 SE Husband

In memory of

ANDREW McKIBBON

Died/July 6 1881

Aged/54 Yrs.

Tho' lost to sight, to memory dear

NE Wife/In memory of

JANE KERR/Wife of

ANDREW McKIBBON

Died/May 2 1889

AE 69 Yrs

- 142 against 143
In memory of
HADWEN P.W.
Son of REV.A & M.A.
EDWARDS
Died/Feb.14,1879
AE 2 Weeks/1 day
- 143 E. JOSEPH WILKINSON
1849 - 1922
WILKINSON
- 144 E. JAMES BRADBURN
Born/Mar.23,1855
Died/Mar.23,1872
AE 17 Yrs.
- 145 E. HOPPER
WILLIAM HOPPER
1836 - 1920
His wife
MARGARET J./PRIER
1842 - 1880
- 146 E. WILLIAM GEDDES
Died Apr.12 1906
Aged 84 Yrs.
Also his wife
MARY McLEAN
Died Jan.25 1908
Aged 82 Yrs
Gone but not forgotten
GEDDES
W. DAVID/Son of
WM.& MARY GEDDES
Died Dec.8 1896
Aged 41 Y'rs.
In life beloved,in death lamented
CHRISTINA GEDDES
Died Jan.23,1934
- 147 E. SCOTT
ROBERT SCOTT
Died Dec.4 1907
Aged 67 Yrs.5 Days
Also his wife
MARY ANN
Died Oct.13 1886
Aged 43 Yrs.
And their infant son WILLIAM
ALLAN R. 1847 - 1935
M.AGNES 1876 - 1947
- 147 W. GRACE DELGARNO
Beloved wife of
JOHN T.SCOTT
Died May 8 1900
Aged 27 Yrs.11 Mo.14 Ds.
JOHN T.SCOTT
1868 - 1960
JAMES A. SCOTT
Apr.19 1870 - Feb.3,1944
His wife
ELIZABETH DALGARNO
Apr.22 1875- Feb.5 1944
MARY E. 1866 - 1954
1883 WALTER S.SCOTT 1959
5 footstones
ALLAN R./M.AGNES/MARY E.
FATHER /MOTHER
- 148 E. B/In/Memory of
THOMAS BRYDGES.
Died Jan.15,1902
Aged 77 Yrs.
His wife
SARAH McCALLUM.
Died April 26,1921
Aged 85 Yrs.
BRYDGES
N. ABRAHAM/BRYDGES
Died/Feb.6,1923
In his 57th Year
- 149 E. JANE DODDS
Beloved wife of
JAMES WILKINSON
Died Oct.16 1902.
Aged 73 Yrs.10 Mo.& 16 Ds.
Meet me in heaven
JAMES WILKINSON
Died Feb.27 1912
In his 80 Yr.
He has gone to meet her as she
said
1 footstone
MOTHER
- 150 E. W / JOHN WIGHTMAN
June 1867 - Jan.1934
His wife
ISABELLA NETHERY
Mar.1871 - Jan.1943
Baby ROBERT Jan.1908

- 151 E. C/ JOHN CAMPBELL
1841 - 1917
His wife
ISABELLA M. DUNBAR
1849 - 1924
At Rest
Daughter MINNIE
1867 - 1947
- 152 E. WILLIAM K. WHALEY
Died April 26, 1913
In his 39th Yr.
His wife
ELLEN E. WILKINSON
Died Oct. 30 1942
In her 73rd Yr
WHALEY /Father
- 153 E. NICOL/MAGGIE L. NETHERY
Beloved wife of
JAMES B. NICOL
Died Aug. 13 1908
Aged 35 Yrs 25 Ds.
Forever with the Lord
JAMES BUDGE NICOL
June 7 1869
Oct. 14 1948
W. JAMES ELLWOOD NICOL
1906 - 1950
Husband of
ANNIE OLIVE WALTERS
1904 - 1971
footstones/FATHER/J.E.N.
MOTHER/FATHER /MOTHER
- 154 T. YUILL
E. ROBERT YUILL
Died Dec. 5, 1908
Aged 61 Yrs. 8 Mos
Also his beloved wife
ELIZABETH BOYD
Died June 12, 1901
Aged 49 Yrs. 2 Mos.
- 155 E. JANE /Beloved wife of
DAVID FARRIER
Died Apr. 14, 1904
Aged 75 Yrs.
More than conquerors at last
here they find their sorrows o'er
DAVID FARRIER
Died Feb. 4 1912
Aged 89 Yrs.
- 156 E. JOHN W. GRASBY
Dec. 1863 - Jan. 1934
His wife
MARY JANE BRIDGES
1868 - 1950
THOMAS A. GRASBY
Jan. 1893 - Feb. 1960
His wife
MARY I. NESBIT
June 1887 - Aug. 1979
W. GRASBY
- 157 E. THOMAS/ANDERSON
Died/Mar. 1 1897
AE 70 Y'rs/9 Mos
Not lost, but gone before
ANDERSON
N. JANE/MARSHALL
Wife of /THOMAS/ANDERSON
Died/Nov. 26, 1919
AE 91 Yrs./6 Mos 21 Dys.
- 158 E. JOHN TAYLOR
Died/May 13 1894
AE 31 Y'rs/11 Mo. & 13 Ds.
Infant/Dau. of
JOHN & AGNES/TAYLOR
We lov'd him yes, no tongue can
tell
How much we lov'd him, and how
well
God lov'd him too and he though
best.
To take him home with him to
rest
TAYLOR
- S. AGNES BELL/Wife of/JOHN TAYLOR
1862-1959/s.m.C. & J. Brussels
- 159 T. AT REST
E. They have reached home
and look for the coming
of their children and
friends
MILLER / Huron
N. In/Memory of
ISABELLA/HALL
Bel'd wife of
ROBT MILLER
Fell asleep in Jesus
Nov. 6, 1869
Aged/56 Years
S. In/Memory of
ROBT. MILLER
Entered into rest
June 15, 1887
Aged/75 Years

- 160 E. McCLELLAND
In loving memory of
CHARLES McCLELLAND
Who died Oct.15,1911
Aged 85 Yrs.
Also his beloved wife
MATILDA SPENCE McCLELLAND
Who died Oct.13,1887.
Aged 62 Yrs.
Also/JAMES McCLELLAND
Their dearly loved son
Who died Aug.7,1887
Their memory is blessed
W. In loving memory of
ALEX.McCLELLAND
Died May 23,1914
Faithfull unto death.
Also/J.CHAS.McCLELLAND
Who entered into life eternal
April 17,1925
MATILDA McCLELLAND
May 9,1943
MARGARET A McCLELLAND
June 13,1944
- 161 E. In memory
THOMAS SHOEBOTTOM
1879 - 1950
His wife
ESTHER N.BRYDGES
1878 - 1966
W. SHOEBOTTOM
- 162 E. ANN/BRYDGES.
Died/Apr.12,1885
AE 57 Yrs.
- 163 E. WIGHTMAN
THOMAS WIGHTMAN
Died
July 13,1882,Aged 56 Yrs
GRACE A.WIGHTMAN
Died Sep.11,1880 Aged 22 Yrs
ALBERT E.son of Edwin & Sarah
Wightman Died Aug.12,1894
Aged 5 Yrs 2 Mos & 16 Dys
W. JOHN WIGHTMAN,
Died/Nov.15,1901,Aged 78 Yrs.
- 164 G. BENNETT
WILLIAM
1866 - 1943
MARGARET
1872 - 1958
- 165 G. ALEXANDER/ FORREST/YOUNG
1928 - 1935
- 166 E. In memory of
BERTHA ROSE HANEY
1892 - 1934
Wife of
JAMES H.VANCAMP
1892 - 1961
W. VANCAMP
- 167 E. In memory of
IDA J.RINTOUL
1889 - 1949
Wife of
PERCY D.McLEAN
1889 - 1973
CORINNE M.McLEAN
1917 - 1965
Beloved wife of
BILL LEDIET
W. McLEAN
3 footstones
MOTHER/FATHER/CORINNE
- 168 E. In memory of
CLARENCE H.WADE
1897 - 1957
Husband of
MARY R.NETHERY
W. WADE
- 169 E. In memory of
JOHN M.COULTES
1890 - 1961
Husband of
ANNIE A LEAVER
1892 - 1971
W. COULTES
2 footstones
JACK / ANNIE
- 170 E. In memory
ORVAL E.TAYLOR
1893 - 1961
Husband of
M.RUBY ROBERTSON
1894 - 1962
W. TAYLOR
2 footstones
MOTHER /FATHER

- 171 E. PROCTER
In loving memory
WILBERT R. PROCTER
1906 - 1968
Husband of
DOROTHY H. STAPLETON
1913 -
footstone/FATHER
- 172 E. KEATING
NORMAN E. KEATING
1908 - 1976
His wife
CELA E. COULTES
1897 - 1973
W. KEATING
- 173 E. HIGGINS
FLORENCE A. PROCTER
1899 - 1979
Wife of
R. GORDON HIGGINS
1895 -
- 173A MCGILL
In memory of
JOSEPH MCGILL
1910 - 1981
EVA M. DICKSON
1913
- 174 E. NETHERY
In loving memory
STELLA J. NETHERY
1889 - 1980
- 175 E. BOLT
IN GOD'S CARE
LESLIE BOLT
1899 - 1980
His beloved wife
M. OLIVE STOKES
1908
footstone/FATHER
- 176 E. VAN CAMP
WILLIAM G VAN CAMP
1896 - 1979
His wife
HAZEL DELL TAYLOR
1901 - 1977
W. VAN CAMP
- 177 E. HIGGINS
W. ROBERT HIGGINS
1887 - 1974
His wife
M. LILA BRYDGES
1895 -
W. HIGGINS
- 178 E. NETHERY
HERMAN NETHERY
1900 - 1981
His beloved wife
ALTA K. HAMILTON
1901 - 1979
- 179 G. WILLIAM H BRECKENRIDGE
1872 - 1948
His wife
SARAH J. MILLER
1874 - 1953
- 180 E. GRIGG
JAMES M.
1880 - 1947
JENNIE
1885 - 1933
Son/WILLIAM
1919 -
Son /GEORGE
1917 -
- 181 G. BABE. son of
J.M. & J. GRIGG
1918
- 182 E. COULTES
In loving memory of
WALTER ASIL COULTES
Jan. 1892 - April 1934
ROBERT H. COULTES
Dec. 1905 -
His beloved wife
MARY ELLEN STONEHOUSE
Feb. 1907 - Nov. 1978
footstone /ASIL
- 183 E. DUNBAR
In loving memory of
AGNES HALLIDAY
Wife of DAVID A. DUNBAR
1865 - 1937
DAVID A. DUNBAR
1860 - 1937
footstones/FATHER /MOTHER
(s.m) J. Grant Clinton

- 184 E. WILLIAM J.
Son of
Wm. & MARY J./SHARPE
Died/Dec. 7, 1883.
AE 27 Yrs 2/Mo's & 21 Ds.
We loved him in life
Let us not forget him
in death
- 185 G. JAMES SHARPE
1841 - 1893
- 186 E. In memory of
JOHN BROOKS
Died/Feb 14, 1885.
AE 60 Y'rs.
A faithfull friend, a husband dear,
A tender husband lieth here;
Great is the loss I here sustain
But hope in heaven to meet again.
S. (s.m.) W. Smyth Wingham
- 187 E. B /WILLIAM BENGOUGH
Died Nov. 4 1905
Aged 78 Yrs. 6 Mo.
AGNES B. STUART
His beloved wife
Died Mar. 6 1903
Aged 82 Yrs.
Blessed are the dead who die in
the Lord.
WILLIAMINA BENGOUGH
1863 - 1953
BENGOUGH
- 188 E. McLEAN/JOHN McLEAN
Sep. 1855 - Oct. 1914
His wife
MARGARET SHEFFIELD
May 1862 - Dec. 1945
ANNIE PEARL
Oct. 1892 - July 1894
(s.m.) Hersey Brussels
W. Flight Lieut
CHESLEY McLEAN
Killed on active service
1896 - 1918
- 189 S. JAMES/PROCTER
Died/June 4, 1895
AE 42 Y'rs/& 9 Mos.
His wife
LOUISA JANE/BARR
Died/Mar. 27 1944
AE 85 Y'rs.
- 189 S. Affections tributes here
I raise
'Tis all that I can do
Till death shall close my
earthly days
Our friendship to renew.
(s.m.) W Vanstone Wingham
PROCTER
- 190 S. JOHN/PROCTOR
Died/May 31, 1898,
Aged/47 Ys. 2 Ms.
Thy will be done.
- 191 E. FERGUSON
ANDREW FERGUSON
1856 - 1944
His wife
ELIZABETH McCURDY
1862 - 1941
WILBURN K.
Bel'd son of
ANDREW AND ELIZABETH
FERGUSON
Died Sept. 26, 1917
Aged 27 Yrs. 6 Mos.
(s.m.) F. Eaton Lucknow
W. ANDREW JOHN,
Infant son of
ANDREW and ELIZABETH
FERGUSON
Died July 29, 1898
Aged 2 Mos. 6 Days.
- 192 E. WHEELER
CHARLES WHEELER,
Died Dec. 5, 1901.
Aged 81 Yrs 5 Mos. 16 Dys.
CAROLINE LAWRENCE,
His wife
Died May 26, 1902.
Aged 83 Yrs. 3 Mos.
2 footstones
FATHER / MOTHER
- 193 E. JAMES CUNNINGHAM
1849 - 1927
MYSIE R. BRUCE
Beloved wife of
JAMES CUNNINGHAM.
Died Feb. 25, 1910 - Aged 61 Yr.
4 Ms.
CUNNINGHAM

- 194 E. IN memory of
 JAMES FERGUSON
 1825 - 1912
 His wife
 LILY PARKHILL
 1826 - 1914
 Their son MATTHEW
 1856 - 1937
 FERGUSON
- 195 E. In life we love
 in death amen.
 In memory of
 MARY E WALSH
 Wife of, JOHN STEWART
 Died July 2nd, 1910
 In her 28th Yr.
 STEWART
- W. ALEXANDER STEWART
 Jan. 1851 - Mar. 1930
 His wife
 ELEN S. STEWART
 June 1850 - May 1929
- 196 E. WATSON
 MARY ELLEN GEDDES
 Beloved wife of
 WILLIAM WATSON
 Died May 30, 1909
 Aged 43 Years.
 WILLIAM WATSON
 Died Oct. 14, 1911
 in his 51 Year.
- S. WILLIE A
 Died/Aug. 4 (1912)
 In his/21 Years
- 197 E. C /WALTER COULTES
 Died May 17, 1909
 Aged 51 Yrs. 11 Mos. 11 Dys.
 Blessed is he that hath part
 in the First Resurrection
 ROBERT COULTES
 Died April 27, 1913
 Aged 82 Yrs.
 His wife MARTHA SCOTT
 1839 - 1921
 (s.m.) S. Wingham
 COULTES
- 198 E. CHARLES PROCTOR
 Died Dec. 2 1899
 Aged 77 Yrs. 2 Mo.
 He being dead yet speaketh
 Heb. II. IV,
 Also his wife
 ELIZABETH
 Died July 16 1902
 Aged 77 Yrs.
 Into thy hands I commend
 my spirit.
- 199 E. JANE KARNEY
 Beloved wife of
 WILLIAM LITTLE
 Died Apr. 18, 1903
 AE 67 Yrs. 8 Ms.
 She was a tender mother here
 And in her life the Lord did
 fear.
 We trust our loss will be
 her gain
 And that with Christ she's
 gone to reign.
- T. LITTLE
- 200 E. In memory of
 HENRY I. PEAREN
 1855 - 1932
 His wife
 CHARLOTTE BENGOUGH
 1860 - 1909
 Dau. MINA E. PEAREN
 1887 - 1976
 W. PEAREN
- 201 E. MATTHEW/PEAREN
 Died/Apr. 19, 1892
 AE 84 Yrs
 Also his wife
 MARY A.
 Died/Feb 20, 1898;
 AE 75 Yrs.
 We loved them in life
 Let us not forget them
 in death.
 PEAREN

- 202 E. In memory of
ROBERT GEDDES
1856 - 1935
His wife
MARY JANE CLARK
1866 - 1932
- 203 E. P /Erected in memory of
PETER PORTERFIELD Jr.
A native of the Township of
East Wawanosh.
Who died in Omaha Nebraska US.
April 15, 1905.
Aged 41 Yrs. 2 Mos.
Boast not thy self of tomorrow
for thou knowest
not what a day may bring
forth.
- MARY STEVENSON
Died June 24, 1921
Aged 78 Yrs. 5 Mos.
PORTERFIELD
- W. P
S. PETER/PORTERFIELD Sr.
Died Dec. 5, 1907
Aged 73 Yrs.
- 204 E. MAXWELL/GARRETT MAXWELL
Died Nov. 16, 1916
In his 80th Yr.
ELLEN McELROY
Beloved wife of
GARRETT MAXWELL
Died Dec. 30, 1911
Aged 75 Yrs.
Into thy hands I commend my
spirit
- W. JOHN MAXWELL
Died Apl. 25, 1912
In his 85th Year.
- 205 E. BRUCE/WILLIAM ATHOL BRUCE
Jan. 1, 1894 - Feb. 24, 1979
His wife
GRACE ELIZABETH SCOTT
Oct. 3, 1901 - Aug. 16, 1978
Infant Daughters.
MURIEL ELAINE 1931
MYRNA DORIS 1937
- W. BRUCE
- 206 E. STUBBS
WILLIAM SNELL STUBBS
Died Feb. 4, 1937
In his 72nd Year
His wife
FRANCES SARAH CHARLTON
Died March 18, 1940
In her 77th Year
Until the day break.
- W. STUBBS
Daughter/LENA PARKINSON
1889 - 1968
3 footstones
FATHER/MOTHER/LENA
- 207 E. In loving memory of
WILLIAM GEDDES
Jan. 8, 1857... Nov. 6, 1938
His wife
SARAH CLARK
Feb. 5, 1863... April 28, 1953
- W. GEDDES
CHARLES JOHNSTON
July 27 1882 - May 27, 1962
His wife
ANNIE M. GEDDES
Oct. 22, 1886 - June 5, 1967
Son MAITLAND
1921 - 1964
5 footstones
FATHER/MOTHER/CHARLES
MABEL/MAITLAND
- 208 E. In memory of
ROBERT J. McCREA
1869 - 1948
His wife
MATILDA WILKINSON
1875 - 1948
- W. McCREA
- 209 E. In memory of
JOHN MCGILL
1881 - 1948
Beloved husband of
CORA M. WILLIAMSON
1886 - 1980
- W. MCGILL
- 210 E. In memory
ROBERT V. BROOKS
1887 - 1955
Husband of
LILLIAN B. McLEAN
- W. BROOKS

- 211 E. In memory of
WILLIAM J. McMURRAY
1880 - 1957
His wife
MARY ANN WALSH
1881 - 1957
W. McMURRAY
2 footstones
MOTHER / FATHER
- 212 E. McCREA/
FRANCES ELIZABETH
1875 - 1965
- 213 E. SARGEANT
FRANCES L.
1908 - 1977
- 214 E. VANNAN
LAWRENCE VANNAN
1894 - 1976
His wife
MILDRED PERDUE
1904 -
W. VANNAN
- 215 E. HIGGINS
In loving memory
NELSON HIGGINS
1889 - 1969
Husband of
SELENA WHEELER
1894 -
W. HIGGINS
- 216 E. PENGELLY
In loving memory
PAULINE KAUFMAN
1908 - 1973
Wife of
GORDON PENGELLY
footstone / MOTHER
- 217 E. In loving memory
ALEXANDER
1908 - 1979
LAURETTA
1910 -
McBURNEY
W. McBURNEY
- 218 G. G. HARVEY COOK
1911 - 1973
Husband of
GRACE E. COOPER
1907 -
Their Daughter JUNE E.
1946 -
- 219 E. BLACK
In loving memory
MARY H. WIGHTMAN
1903 - 1971
Wife of
CECIL BLACK
1901 -
W. BLACK
- 220 G. CAMPBELL
MARILYN J. PENGELLY
1943 - 1968
Beloved wife of
ALLAN J. CAMPBELL
- 221 E. CAMPBELL
In loving memory of
FLOYD L. CAMPBELL
1902 - 1969
Beloved husband of
OLIVE E. HELM
- 222 E. COOK / In memory of
D. TELFORD COOK
1902 - 1967
His wife
BERTHA J. COOPER
1905 -
W. COOK
footstone / TELFORD
- 223 E. VAN NORMAN
In memory of
CHARLES SIMON VAN NORMAN
1877 - 1964
His beloved wife
MARY JEAN DOLL
1883 - 1959
- 224 E. PROCTER
In memory of
LEELAND PROCTER
1899 - 1966
His wife
MARGARET CAMPBELL
1904 - 1964
W. PROCTER
- 218A.G SON. / FREDERICK P.
1940 - 1977

- 225 E. In memory of -
WILLIAM McGREGOR
1874 - 1955
His wife
JANET SKINN
1881 - 1965
W. McGREGOR
- 226 E. In memory of
FRANCES STONEHOUSE
1871 - 1948
Beloved wife of
J.HARRY HOPPER
1871 - 1955
AT REST
W. HOPPER
- 227 E In memory of
ELIZABETH A.HARRISON
1864 - 1945
Wife of
WILLIAM C.SCOTT
1872 - 1954
ANNIE B.SCOTT
1871 - 1946
Wife of
HARRY KIRKBY
1872 - 1956
W. SCOTT — KIRKBY
- 228 E. WILKINSON
MARY JANE WALSH
Wife of
W.B.WILKINSON
July 1861 - June 1933
W.B.WILKINSON
Nov.1856 - Sept.1946
W. ANN LITTLEFAIR
Wife of
C.B.WILKINSON
Sep.1865 - May 1936
C.B.WILKINSON
Mar.1864 - July 1947
- 229 E. WHEELER
In memory of
CHARLES WHEELER
Died Oct.13,1913
In his 68th Yr.
His wife
MARY ANN WILKINSON
Died Mar.9,1914
In her 86th Yr.
- 229 W. BRIAN JAMES
Infant son of
WILFRED & VELMA/PICKELL
Dec. 5 - Dec.11,1949
- 230 E. THOMAS M WALSH
April 28,1852-Dec.22,1928
His wife
SUSANNAH BELL
Oct.31,1859-Sep.29,1940
WALSH
footstones /FATHER/MOTHER
- 231 E. PROCTER
REBECCA BRANDON
Beloved wife of
THOMAS PROCTER
Died March 1,1912
Aged 55 Yrs,7 Mos.
THOMAS PROCTER
Died Oct.1,1922 -Aged 73 Yrs.
- 232 E. VAN NORMAN
SIMON VAN NORMAN
Died May 23,1920
Aged 85 Yrs.
ELIZABETH MILLER
Beloved wife of
SIMON VAN NORMAN
Who died June 21,1909
The 74th anniversary of her
birth
An unselfish sympathetic kindly
heart.Whose/submission to God's
will,and thankfullness for/
his mercies,made her the sweet-
est character/we have ever know
- 233 F. Wife/JOSEPHINE VAN NORMAN
1893 - 1978
- 234 Husband/JAMES FINDLATER
1887 - 1958
- 235 E. In memory of
BARBARA J.McPHEE
1862 - 1946
Wife of
ROBERT VAN NORMAN
1862 - 1948
In The Garden
VAN NORMAN

- 236 E. CLEGG/GEORINA FINDLATER
Wife of JOHN CLEGG
1863 - 1920
Faithfull To Her Trust
JOHN CLEGG
1865 - 1936
Daughter - ROBINA
1887 - 1964
Daughter - IRENE
1891 - 1966
(s.m.) Hersey Brussels
- 237 E. IDA A.
Beloved Daug.of
JAMES H.& REBECCA
BRANDON
Died Oct.28,1910
Aged 22 Yrs.5 Mos.
She died as she lived
trusting in God.
- 238 E. L /AGNES E.BRANDON
Wife of/JAMES H.LIND
Jan.1874 - Aug.1921
Their infant BABE 1903
(s.m.) R.Spotton Wingham
- 239 E. N / ELIZABETH W/NICHOLSON
Beloved wife of
CHAS.F.NICHOLSON
Died Jan.15,1931
Aged 47 Yrs 5 Mos.
- 240 E. In/Memory of
WM.ABRAHAM
Died/Feb.18,1905
Aged 87 Yrs.
ABRAHAM
(s.m.)W.S.Tone Bros.Wingham
- N. In/Memory of
MARGERY/Bel'd Wife of
WM ABRAHAM
Died/Oct.28,1898
AE 82 Y'rs/& 5 Mo's
Native of /Ireland
A loving wife with children dear
In silence all be sleeping here
Great is the loss we here sustain
But hope in heaven to meet again
- 241 E. ISABELLA/Wife of DAVID GEDDES
Died Jan.30,1901
AE 68 Y'rs 9 Mos 18 D's
DAVID GEDDES
Died Oct.20,1909
Aged 82 Yrs.
GEDDES
- N. ISABELLA /Dau.of
DAVID & ISABELLA/GEDDES
Died/Dec.18,1892
AE 25 Y'rs/2 Mos.
M.W.GEDDES
Widow of/I.WILSON
Died/Dec.24,1943
AE 85 Y'rs.
- 242 SE In/Memory of
JOSEPH DUNBAR
Died March 31,1890
AE 74 Yr's
DUNBAR
- N. In/Memory of
SUSAN DUNBAR
Died June 28,1887
AE 60 Yr's
- 243 Old stone beside 12
15 Oct. /aged 50 years
Also of his _____
MARY PARAN
Who died Dec.3,1867
Aged 75 Years
- 244 E. JOHN BONE/Died
Oct.3,1892
Aged/60 Y'rs,27 Ds.
Native of/Dumfrieshire
Scotland
Be ye also ready,for in
such an hour
As ye think not the son
of man cometh.
Matt.24,xliv
BONE
- N. MARY OAK/Wife of
JOHN BONE
Died/Dec.25,1902
Aged/67 Y'rs 10 Ds.

245 E. WHEELER/DANIEL WHEELER
Died June 13, 1913
Aged 67 Years
Native of Essex England
At Rest

His wife. ELIZA
Died Jan. 20, 1914
Aged 69 Years

246 E. JAMES TAYLOR
1877 - 1939
His wife
JENNIE ISABELLA
1878 - 1978
TAYLOR

footstone / FATHER

247 E. McGUIRE/In memory of
W. JOHN McGUIRE
1858 - 1939

His wife
MARY ANN SOWLER
1862 - 1955
PTE. ELMER McGUIRE
1889 - 1918
Buried at Bramshott
England

W. HORACE W. SOWLER
1885 - 1960
His wife
LELAH SOWLER
1883 - 1960

248 E. SCOTT/WILLIAM E. SCOTT
1868 - 1947
Husband of
ALMA SACKRIDER
1874 - 1948

249 E. ALEXANDER BRUCE
1860 - 1941
His wife
SUSAN J. McGREGOR
1864 - 1939

250 E. In memory of
CHARLES J. KEATING
Feb. 20, 1878 - Apr. 8, 1939
His wife
ANNIE EDWARDS
1883 - 1958

footstones/FATHER/MOTHER

W. KEATING

251 E. In memory
HAZEL B. CAMPBELL
1892 - 1960
Wife of
JESSE WHEELER
1889 - 1968

footstone/WIFE /HUSBAND

W. WHEELER

252 E. GARNISS/JOHN GARNISS
1887 - 1963
His wife
LUCY S BRAY
1888 - 1963

footstones /FATHER / MOTHER

W. GARNISS

253 E. COOK/JOHN S
1928 - 1967
footstone DADDY

W. COOK

254 E. CLOAKEY
In loving memory of
STUART E. CLOAKEY
1920 - 1969
Beloved husband of
IVY L. CAMPBELL

W. (s.m.) Cemetery Memorials
Stratford

255 E. WALSH/JAMES T.
1902 - 1979
Husband

JENNIE M.
1905
Wife

footstone /DAD
cornerstones /W

W. WALSH

(s.m.) T. Pryde & Sons
main St. Exeter

256 E. NOBLE
ROY NOBLE-1901 - 1975
His wife
LUELLA McGREGOR
1902 -

W. NOBLE

257 E. STONEHOUSE
 NORMAN STONEHOUSE
 May 6, 1897-Feb. 16, 1975
 Beloved husband of
 VIOLA E. BLACKWELL
 God Is Our Refuge
 (s.m.) Ideal Monuments
 Works Ltd.
 London Ont.

258 E. STONEHOUSE
 Wife/MYRTLE/HENRY
 1904 - 1977
 Husband/MARSHALL/STONEHOUSE
 1896 - 1970
 (s.m.) Stratford Cemetery Memorial

259 E. DUNBAR/Mother
 MARGARET W./BRYDGES
 1902
 Father/JOSEPH E/DUNBAR
 1897 - 1970
 (s.m.) Stratford Cem. Memorial

260 E. HOPPER.
 MARY EMMA LAKE
 1895 - 1969
 Beloved wife of
 LYLE S. HOPPER
 1895 - 1971
 (s.m.) Wingham Memorials

261 E. McBURNEY
 In memory of
 JOHN C. McBURNEY
 1900-
 Beloved Husband of
 ROBENA M YOUNG
 1910 -

262 E. In memory of
 JOHN T. GARNISS
 1862 - 1951
 Beloved husband of
 CHARLOTTE S. SAVAGE
 1878 - 1959
 W. GARNISS

263 E. SCOTT/JOHN S. SCOTT
 1868 - 1947
 ALICE E. HARRISON.
 His beloved wife.
 1869 - 1954
 At Rest

W SCOTT

264 E. In memory of
 ANNIE L. HARRISON
 Nov. 1859 - Sept. 1940
 footstone /AUNT ANNIE
 W. HARRISON

265 E. DUNBAR/ WILLIAM G.
 1891 - 1940
 Beloved husband of
 AGNES McCALLUM
 1893 -
 (s.m.) London Marble & Granite

266 E. FELS/JOHN E. FELS
 1865 - 1944
 His beloved wife
 ANNIE H. B. SCOTT
 1872 - 1940
 footstone MOTHER
 4 corner stones/FELS
 (s.m.) London Marble & Granite

267 E. In Memory
 JAMES F. YOUNG
 1869 - 1940
 Husband of
 ISABELL McCORMICK
 1879 - 1964
 W. YOUNG

268 E. In Memory of
 WILLIAM J. GEDDES
 1860 - 1941
 His wife
 ISABELLA McKENZIE
 1864 - 1948
 2 footstones/FATHER/MOTHER
 W. GEDDES

269 E. In/Memory of
 MARGARET L.
 Wife of/WM. BONE
 Feb. 3, 1890
 Aged/29 Y's 2 M's
 Their Dau./ANNIE S.
 Died/MAR. 2, 1884
 Aged/3 M's 21 D's
 BONE
 2 footstones
 M.L.B.
 A.L.B.

- 270 E. J /MARTHA DAVIDSON
Wife of
SAMUEL JORDAN
1865 - 1919
SAMUEL JORDAN
1863 - 1943
Their Son
WM. J.
1888 -1917
- 271 E. L /SUSANNA SHERRY
Beloved wife of
CHARLES W.LAWRENCE
Died Jan.28,1886
Aged 40 years
CHARLES W.LAWRENCE
Died May 12,1908
Aged 65 Yrs.3 Mos,26 Dys.
WILLIAM W./son of
C.W.& SUSANNA LAWRENCE
Died Mar.21,1904
Aged 26 Yrs.11 Mos.19 Dys.
LAWRENCE
- 272 N. In/Memory of
JOHN / son of
W.H.& ANNIE B.
STONEHOUSE
Died / Dec.24,1891
AE 9 m's 14 D's
Suffer little children to come
Unto me.And forbid them not for
such is the kingdom of heaven
- S. In/Memory of
W.H.STONEHOUSE
Died/Feb.24,1892
Aged 3 Yrs/5 M's 9 Ds.
Be ye also ready for in such an
hour as ye think not the
Son of near cometh
- 273 E. STONEHOUSE
CHRISRIE STONEHOUSE
Wife of T.M.RUSSELL
Aug.21,1876-Sept.16,1909
RICHARD STONEHOUSE
Died Mar.27,1910
In his 85th Yr.
Also his wife
ELIZABETH RATH
Died Nov.23,1906
In her 74th Yr.
W. LORNE C.STONEHOUSE
July 20,1898 - Dec.8,1943
- 274 E. MARGARET / ANDERSON
Wife of SAMUEL WALSH
1849 - 1912
SAMUEL I.WALSH
1850 - 1931
- 275 E. SCANDRETT
JOHN SCANDRETT
Died Feb.22,1916
In his 68th Year
His wife SARAH ORR
died May 5,1926
In her 71,Year.
Gone but not forgotten
(s.m.) Hersey Brussels
2 cornerstones
- 276 E. In memory of
W.GARNER NICHOLSON
1849 - 1940
His wife
ALICE M.OSBORNE
1875 - 1961
Daughter AGNES 1914
JAMES NICHOLSON
1846 - 1911
W. NICHOLSON
- 277 E. JENNIE MCKENZIE
Beloved wife of
ROBERT ARMSTRONG
Born Nov.11,1868
Died Aug.23,1915
ARMSTRONG
- 278 E. ROBERT M.ANDERSON
Died April.13,1917
Aged 59 yrs.
His wife
ELIZABETH J./WILKINSON
Died Mar.23,1945
Aged 85 Yrs.
ANDERSON
- 279 E. R / MARGARET R.BRIDGES
Wife of / J.RUDDY
Died May 5,1916
Aged 51 Yrs
JOSEPH D RUDDY
Died Jan.4.1932
Aged 70 Yrs.

- 280 E. MASON / JOHN MASON
1887 - 1960
His wife
ETHEL CLARK
1895 - 1980
1 footstone / FATHER
- 281 E. COLE/LILY M.SCANDRETT COLE
1879 1949
Mother
WILLIAM J COLE
1877 1943
Father
- 282 E. MARY LILLIAN COLE
Died Sep.25,1916
Aged 5 Mos.20 D's
Daughter of
W & LILLIE COLE
footstone / BABY
- 283 E. ANDERSON
Mother / SARA J.
1903 -
Father / EARL
1898 - 1974
- 284 BABY
ERIC MOY
July 1980
- 285 E. A / DAVID A.ANDERSON
Died Mar.26,1916
Aged 19 Yrs.1 Mo.18 D's
JAMES ANDERSON
1864 - 1938
His wife
MARY J.SPROAT
1871 - 1949
Asleep in Jesus
2 Footstones/MOTHER/FATHER
(s.m.)Hersey Brussels
W. MARIE LOIS
Daughter of
JOHN & M.ANDERSON
1926 - 1929
- 286 E. ALEXANDER SCOTT
1859 - 1940
Husband of
GRACE TAYLOR
1871 - 1949
JENNIE 1900 - 1917
- 286 E. Edith Daughter of
SOL & V.CLOAKBY
1916 - 1918
W. SCOTT
- 287 E. In memory of
ALICE STONEHOUSE
1860 - 1933
Wife of T.E.NIXON
Their son
JOSEPH 1882 - 1914
2 footstones /MOTHER / FATHER
W. NIXON
- 288 E. In memory of
ROBERT M.STONEHOUSE
Jan.1868 - Apr.1959
Husband of
AGNES JAMIESON
Oct.1866 - Apr.1963
STEWART 1912 - 1913
W. STONEHOUSE
GORDON STONEHOUSE M.D.
1909 - 1961
Husband of
WINONA LAWRENCE
3 footstones
FATHER/GORDON / MOTHER
- 289 E. ROY son of
BASIL & NETTIE
COULTES
Died June 4,1900
AE 2 Yrs 5 Mo's 16 D's
- 290 E. MARIA A./ ELLIS
Died/Jan.18,1887
AE 38 Yrs.
footstone / ETHEL
- 291 E. J.C.R.WIGHTMAN
1845 - 1924
- 292 G. Infant son of
H.S.& FLORENCE/FRISBY/died/
WILLIAM/Jan.2./1918/Aged 3 M's
- 293 E. RUTHERFORD SMITH
1814 - 1885
His wife
MARY RUTHERFORD
1816 - 1894
Natives of Jeoboro Scot.

- 294 E. In loving memory of
CATHERINE A. DUNBAR
Nov. 3, 1888 - July 5, 1942
Wife of MARTIN GRASBY
July 2, 1887 - Jan. 18, 1973
GRASBY
2 footstones
FATHER / MOTHER
- 295 E. In memory of
CHARLES JOHNSTON
1860 - 1943
- 296 E. In memory of
GEORGE CUNNINGHAM
1879 - 1941
His wife
SUSAN DUNBAR
1887 - 1947
2 footstones FATHER/MOTHER
W. CUNNINGHAM
- 297 E. BRYDGES
In memory of
WILLIAM T. BRYDGES
1893 - 1959
His wife
JOSEPHINE JOHNSON
- 298 E. BRADBURN
A. MELVILLE BRADBURN
1893 1965
His wife
HESTER L. JOHNSON
1895 -
footstone / FATHER
- 299 E. In memory
THOMAS SMITH
1894 - 1962
footstone / FATHER
W. SMITH
- 300 E. McNALL
In loving memory of
JULIA E. McNALL
April 30, 1909 - Nov. 12, 1972
A dear Mother
footstone
MOTHER
(s.m.) Wingham Memorial
- 301 E. LOGAN
In loving memory
CLIFFORD LOGAN
1914 - 1977
Husband of
DOROTHY VINCENT
1913 -
- 302 E. LAMONT
JAMES KENNEDY LAMONT
1929 -
Husband of
MARGARET IRENE SMITH
1932 -
Beloved son
DANIEL WALTON 1958 - 1979
(s.m.) Wingham memorials
- 303 E. McSWEEN
EDNA M VINCENT
1919 - 1980
Beloved wife of
GEORGE R McSWEEN
1905 - 1980
(s.m.) Wingham Memorials
- 304 E. HOPPER
In loving memory of
STANLEY HOPPER
1927 - 1974
Beloved husband of
JEAN SHARPIN
1927 -
W. HOPPER
(s.m.) Wingham Memorials
- 305 E. SCOTT
In loving memory of
WALTER H SCOTT
Jan. 27, 1907 - Feb. 23, 1974
Beloved husband of
ALICE L. SHACKLETON
Mar. 8, 1909
W. SCOTT
(s.m.) Stratford Cemetery
- 306 E. ANDERSON
In loving memory
JOHN G. ANDERSON
1893 - 1970
Husband of
MYRTLE A. WHEELER
1896 - 1973
W. ANDERSON

- 307 E. WIGHTMAN
J. EDGAR
1909 -
WINNIFRED
1909 - 1965
AT REST
W. WIGHTMAN
- 308 E. WILLIAM C. MCGREGOR
1911 - 1970
Husband of
ROSELLA M SHIELL
1917 - 1970
- 309 E. JOHNSON
In memory of
HENRY JOHNSON
1859 - 1951
His wife
MARGARET GOLLEY
1862 - 1918
ANNIE M. 1891 - 1915
CHARLOTTE M. 1890 - 1916
W. JOHNSON
In memory of
WILLIAM JOHNSON
1823 - 1905
His wife
CHARLOTTE COLTON
1822 - 1888
Their son
THOMAS 1863 - 1926
7 footstones
GRANDPA/GRANDMA/FATHER
MOTHER /THOMAS/ANNIE M
C. MABEL
- 310 E. CAMPBELL
Husband /IRA/CAMPBELL
1878 - 1975
Wife/GERTRUDE/GARNISS
1878 - 1973
(s.m.) Wingham Memorials
- 311 E. In memory of
HENRY CAMPBELL
1884 - 1947
Husband of
ELIZABETH BRUCE
1891 - 1970
2 footstones
ELIZABETH/HENRY
- 312 E. In memory of
ROBERT E. MCKENZIE
1867 - 1943
His wife
HELEN C. STEWART
1867 - 1951
Son JACK 1908 - 1978
Dau. H. LOUISE (GEIGER)
1905
2 footstones /FATHER / MOTHER
- 313 E. ARMSTRONG
In loving memory of
LLOYD ALVIN
1924
Beloved husband of
DORIS G. E. NEWMAN
1932
JOSEPH ALVIN
1890 - 1979
Beloved husband of
A. PEARL DEACON
1893
Infant son 1918
(s.m.) Stratford Cemetery
- 314 E. PTE. JAMES KELLEY
3rd. Batt. C.E.F.
Killed in action at Somme France
Oct. 8, 1916 Aged 35 Yrs.
His wife ESTELLA COOK
Died Sept. 3, 1918
Aged 37 Yrs.
Faithfull to their trust
ALFRED E. COOK
1878 - 1966
W. REBBECCA J. HARRISON
Wife of DAVID COOK
Born Sept. 29, 1856
Died Apr. 4, 1929
DAVID COOK 1846 - 1931
- 315 E. Farewell
WEATHERAL/CROOKS
Died June 8, 1886
Aged 74 Yrs.
Also his wife
CHARLOTTE
Died Feb. 23, 1905
Aged 74 Yrs.

316 G. JAMES WILLIAMSON
1850 - 1937
His wife
MARY J. FERGUSON
1854 - 1890

317 E. MARY A WILLIAMSON
Beloved wife of
JAMES STEWART
Died April 17, 1896
Aged 52 Yrs.
8 Mos. & 26 Ds

In life beloved
In death lamented

318 G. WILLIAM CORBETT
Dear father of
Infant son, and
MURIEL, ELIZA,
and EVELYN

319 E. BRYANS
JAMES A. BRYANS 1885 - 1963
His wife
ELLA MAE HOPPER 1898 - 1877
At Rest

320 E. HOPPER
JOHN MILTON
Son of
JOHN & ISABELLA HOPPER
1888 - 1918

ISABELLA E VAN NORMAN
Beloved wife of JOHN HOPPER
1866 - 1937

JOHN WM. HOPPER
1862 - 1945

2 corner stones

321 E. MONTGOMERY
Eldest daughter
BERTHA
Died Jan. 27, 1920
Aged 27 Yrs, 3 Mo.

Beloved Daughter
MAGGIE SARAH
Died June 28, 1919
Aged 16 Yrs, 6 Ms.

w LIZZIE PEARL
Beloved Daughter of
THO'S and ELIZABETH
MONTGOMERY
Died May 6, 1918
Aged 22 Yrs. 3 Ms.

Safe in the arms of Jesus
(s.m.) F. Eaton Lucknow

321 W. THOMAS M. MONTGOMERY
1861 - 1928
His wife
ELIZABETH McMICHAEL
1867 - 1951

FRANCES MARY JACKSON
1911 - 1946
Wife of
LLOYD MONTGOMERY

3 cornerstones M.

Brandon Cemetery

Con 9 Lot 42 E. Wawanosh Twp.

Index

Women indexed under maiden and married names.

Inferred names marked with *.

ABRAHAM

Margery #240
Wm. 240

AITKEN,

Margaret I. (SCOTT) #100

ALLISON,

Isabella #47
Isabella (McCALLUM) 47
Susan 47, 48
Walter 47

ANDERSON,

David A. 285
Earl 283
Elizabeth J. (WILKINSON) 278
Euphemia (ARMOUR) 39
Findlay 79
James 39, 285
James D. 39
Jane (MARSHALL) 157
Jean (KELLY) 101
John G. 306
Julia A. 306
Julia Ann (NAYLOR) 79
Julia Ann (SCANDRETT) 116
Margaret M. 79
Margaret (WALSH) 274
Marie Lois 285
Marion 285, 39
Mary J. (SPROAT) 285
Myrtle A. (WHEELER) 306
Robert M. 278
Sara J. 283
Thomas 157

ARBUCKLE,

Edythe M. (COULTES) #18

ARMOUR,

Euphemia (ANDERSON) #39

ARMSTRONG,

A. Pearl (DEACON) #313
Doris G. E. (NEWMAN) 313
Eleanor (McASH) 83
G. Wilbert 69
Infant son 313
Jennie (McKENZIE) 277
Joseph Alvin 313
Lloyd Alvin 313
M. Verda (PROCTOR) 69
*Robert 277

BARR,

Louise Jane (PROCTOR) #189

BEECROFT,

Ann Jane (CAMPBELL) #42

BELL,

* A. #140
Agnes 158
* C 140
* Frances 86
Jennie (GARNISS) 3
* John 86
John T. 3
Margaret (Walsh) 12
Susannah (WALSH) 230
W. Frederick 86
Baby 140

BENGOUGH,

Agnes B. (STEWART) #187
Charlotte (PEAREN) 200
William 187
Williamina 187

BENNETT,

Margaret #164
William 164

BLACK,

Cecil #219
Etta M. (COOK) 58
G. Harvey 1
Lila E. (COOK) 1
Margaret (WIGHTMAN) 85
Mary H. (WIGHTMAN) 219
Thomas 25

Brandon Cemetery Index

BLACKWELL,
Viola E. (STONEHOUSE) #257

BOLT,
Leslie #175
M. Olive (STOKES) 175

BONE,
Annie S. #269
Margaret L. 269
Mary (OAK) 244
John 244
* Wm. 269

BOYD,
Elizabeth (YUILL) #154

BRADBURN,
A. Melville #298
Hester L. (JOHNSON) 298
James 144
Vera O. (McCREA) 97

BRANDON,
Agnes E. (LIND) #238
Ann (SHARP) 121
Annie 121
Clark M. 122
Dora A. (WRAY) 98
Ida A. 237
* James 121
James H. 122, 237
Jane Ann (LAWLOR) 94
Jas. 126
John P. 126
Joseph A. 98
Margaret 122
Margaret J. 121
Marjorie S. (BRYDGES) 125
Mary 126
Matthew 94, 121
Rebecca (PROCTOR) 231, 237
Wm. Henry 125

BRAY,
Lucy S. (GARNISS) #252

BRECKENRIDGE,
Sarah J. (MILLER) #179
William H. 179

BRETZ,
*Gerhard #93
Rebecca (JACOBS) 93

BRIDGES,
Josephine (JOHNSON) #297
Margaret (RUDDY) 297
William T. 297

BROOKS,
Elva M. (PROCTOR) #26
John 186
Lillian B. (McLEAN) 210
Robert V. 210

BROWNRIDGE,
Mary A. (PROCTOR) #51

BRUCE,
Alexander #249
Edith M. (McCALLUM) 110
Elizabeth (CAMPBELL) 311
Esther B. (McCALLUM) 104
Grace Elizabeth (SCOTT) 205
Minnie (CHAMNEY) 75
Muriel Elaine 205
Myrna Doris 205
Mysie R. 193
Susan J. (McGREGOR) 249
William Athol 205

BRYANS,
Ella Mae (HOPPER) #319
James A. 319

BRYDGES,
Abraham #148
Ann 162
Archibald 52
Archibald Wm. 120
Eliza (McCREA) 28
Elizabeth (JOHNSON) 52
Esther N. 161
James T. 120
Jean (WHEELER) 120
Jeremiah 28
Jerrie 120
M. Lila (HIGGINS) 177
Margaret R. (RUDDY) 279
Margaret W. (DUNBAR) 259
Marjorie S. (BRANDON) 125
Mary Ellen 28
Mary Jane (GRASBY) 156
Sarah (McCALLUM) 148
Thomas 148
Tha's Noble 52

Index Brandon Cemetery

BUCHANAN,
 John #16
 Mary E. (COOK) 16
 Violet (COOK) 30
 BURCHILL - Alice (NICHOLSON) #34
 CAMPBELL, Allan J. #220
 Ann Jane (BEECKOFT) #42
 C. A. , Sergt. 42
 Charles 42
 Elizabeth (BRUCE) 311
 Floyd L. 221
 Gertrude (GARNISS) 310
 Hazel B. (WHEELER) 251
 Henry 311
 Ira 310
 Isabella M. (DUNBAR) 151
 *Ivy L. (CLOAKEY) 254
 J. Viola (WIGHTMAN) 42
 John 151
 Margaret (PROCTOR) 224
 Marilyn J. (PENGEELLY) 220
 Mary J. (TASKER) 38
 Maude (McDOWELL) 43
 Minnie 151
 Olive E. (HELM) 221
 CEASAR,
 Isabella (McDOUGALL) #45
 William 45
 CHAMNEY,
 Carl Bruce #75
 Minnie (BRUCE) 75
 Richard 75
 CHARLTON,
 Frances Sarah (STUBBS) #206
 CLARK,
 Ethel (MASON) #280
 Mary Jane (GEDDES) 202
 Sarah (GEDDES) 207
 CLARKE,
 Margaret (WILKINSON) #11
 CLEGG,
 Georgina (FINDLATER) #236
 Irene 236
 John 236
 Robina 236
 CLOAKEY,
 Edith #286
 Ivy L. (CAMPBELL) 254
 Sol. 286
 Stuart E. 254
 U. 286
 CODE,
 Maud (PORTERFIELD) #114
 COLDWELL,
 Eliza #87
 *James 87
 COLE,
 Ann (McKENZIE) #29
 John 29
 Lily M. (SCANDRETT) 281
 Mary Lillian 282
 William J. 281
 COLTON,
 Charlotte (JOHNSON) #309
 COOK,
 A. Edna #15
 Alfred E. 314
 Bertha J. (COOPER) 222
 D. Telford 222
 David 314
 Estella (KELLEY) 314
 Etta M. (BLACK) 58
 Frederick J. 15
 Frederick W. 30, 58
 G. Harvey 218
 George E. 17
 Grace E. (COOPER) 218
 John S. 253
 John W. 15
 June E. 218
 Lila E. (BLACK) 1
 Mary E. (BUCHANAN) 16
 Mary M. (HARRISON) 30
 Olive E. (HELM) 221
 Rebecca J. (HARRISON) 314
 Stanley 30
 Thomas 61
 Violet (BUCHANAN) 30
 COOPER,
 Bertha J. (COOK) #222
 Grace E. (COOK) 218

Index Brandon Cemetery

CORBETT,

Eliza #318
 Evelyn 318
 Infant son 318
 Muriel 318
 William 318

COULTES, Albert N. #22

Albert E. #21
 Alice A. (TYNDALL) 78
 Annie A. (LEAVER) 169
 Basil 289
 Cela E. (KEATING) 172
 Edythe M. (ARBUCKLE) 18
 Ellen (MILLER) 78
 Florence M. (SCOTT) 21
 George F. (KEATING) 63
 James R. 18
 Jennie (LEAVOR) 63
 John 78
 John M. 169
 Mable I. (WHEELER) 65
 Martha (SCOTT) 197
 Mary Ellen (STONEHOUSE) 182
 Mary (TURVEY) 27
 Nettie 289
 Robert 27, 197
 Robert H. 182
 Roy 289
 Walter 197
 Walter Asil 182

CROOKS, Charlotte (WEATHERAL) #350

CROWE,

Sarah E. (WRAY) #90

CURTIS,

Grace (PROCTOR) #70

CUNNINGHAM,

George #296
 James 193
 Lizzie (SCOTT) 57
 Mysie R. (BRUCE) 193
 Susan (DUNBAR) 296

DALEY,

George #10
 Mary Ann (WRAY) 10
 Mary E. (FERGUSON) 9

DALGARNO,

Elizabeth (SCOTT) #147
 Grace (SCOTT) 147

DARROCH,

Margaret (FORBES) #127

DAVIDSON,

Martha (JORDAN) #270

DEACON,

A. Pearl (ARMSTRONG) #318

DICKSON,

Eva M. (McGILL) #173A

DODDS,

Jane (WILKINSON) #149

DOLL,

Mary Jean (Van NORMAN) #223

DOUGALL,

Isabella #80

DUNBAR,

Agnes (HALLIDAY) #183
 Agnes (McCALLUM) 265
 Catherine A. (GRASBY) 294
 David A. 183
 Joseph 242
 Joseph E. 259
 Isabella M. (CAMPBELL) 151
 Margaret W. (BRYDGES) 259
 Susan 242
 Susan (CUNNINGHAM) 296
 William G. 265

EDWARDS, * A., Rev. #142

Annie (KEATING) #250
 Hadwin P. W. 142
 *M. A. 142

ELLIS,

Ethel #290 ?
 Maria A. 290
 Elizabeth (SCOTT) #6

FARRIER,

David #155
 Jane 155

FELLS,

Annie H.B. (SCOTT) #266
 John E. 266

Index Brandon Cemetery

FERGUSON,

Andrew #191
 Andrew John 191
 Daniel F. G. 60
 Elizabeth (McCURDY) 191
 James 194
 James A. 60
 John J. 9
 Lily (PARKHILL) 194
 Mary E. (DALEY) 9
 Mary J. (WILLIAMSON) 316
 Matthew 196
 Wilburn K. 191

FINDLATER,

Georgina (CLEGG) #236
 James 234
 Josephine (Van NORMAN) 233

FORBES,

Elizabeth A. (KERNEY) #128
 Margaret (DARROGH) 127
 Robert 127
 Robert John 128
 Thomas William 128

FRASER,

Isabella (GEDDES) #96

FRISBY,

*Florence #292
 *H.S. 292
 William 292

GALLAGHER,

Leslie #53
 Margaret D. (MILLER) 53
 Mary G. 53
 * Robert 53

GARNISS,

Charlotte S. (SAVAGE) #262
 Gertrude (CAMPBELL) 310
 Lucy S. (BRAY) 252
 Jennie (BELL) 3
 John 252
 John T. 262

GEDDES,

A. Lorraine (VARDON) #24
 Annie M. 25
 Annie M. (JOHNSTON) 207
 Christina 146
 David 146, 241
 Ernest 23
 Isabella 25, 241
 Isabella (FRASER) 96
 Isabella (McKIENZIE) 268
 John A. 96
 M. Cameron 25
 Mary Ellen (WATSON) 196
 Mary Jane (CLARK) 202
 Mary I. 24
 Mary (PORTERFIELD) 23
 M. W. (WILSON) 241
 Norman M. 25
 Robert 202
 Sarah (CLARK) 207
 Stewart P. 24
 William 146, 207
 William J. 268
 Mary (McLellan) 146

GEIGER,

H. Louisa (McKENZIE) #312

GOLLEY,

Margaret (JOHNSON) #309

GOOD,

Levi, Sr. #113
 Rosetta (KINZIE) 113

GOODFELLOW,

Geo. #4

GOOKS,

Charlotte #315
 Weatheral 315

GRASBY,

Catherine #294
 John W. 156
 *Martin 294
 Mary Jane (BRYDGES) 156
 Mary I. (NESBITT) 156
 Thomas A. 156

Index Brandon Cemetery

GREGG,
Russell G. #46A

GRIGG,
A. M. #46
Babe 180
C.E. 46
*Caroline 46
George 180
James 82
James M. 180
Jemima 82
Jennie 180
Martha (JOHNSTON) 77
Thomas Wm. 46
William 7, 180
*Wm. 46

HALL,
Isabella (MILLER) #159

HALLIDAY,
Adam #55
Agnes (DUNBAR) 183
Catherine (ROBERTSON) 55

HAMILTON,
Alta K. (NETHERY) #178

HANEY,
Bertha Rose (Van CAMP) #166

HARRISON,
Alice E. (SCOTT) #263
Annie L. 264
Elizabeth A. (SCOTT) 227
Mary M. (COOK) 30
Rebecca J. (COOK) 314

HAYES,
*D. #14
James 14
*L. 14

HEDLEY,
*David Dennis #137
Mary Fern (NETHERY) 137

HELM,
*Olive E. (COOK) #221

HENDERSON,
Edna P. (PROCTOR) #68
Lily M. (LEITCH) 111
Mary E. (NETHERY) 130

HENRY,
Evaline #13
Maitland 13
Myrtle (STONEHOUSE) 258
Merle 13
Robert 13

HIGGINS,
Florence A. (PROCTOR) #173
M. Lila (BRYDGES) 177
Nelson 215
R. Gordon 173
Selena (WHEELER) 215
W. Robert 177

HOPPER,
Ella Mae (BRYANS) #319
Ellen M. (PROCTOR) 49
Frances (STONEHOUSE) 226
Isabella E. (Van NORMAN) 320
Jean (SHARPIN) 304
J. Harry 226
John Milton 320
John Wm. 320
Lyle S. 260
Margaret J. (PRIER) 145
Mary Emma (LAKE) 260
Stanley 304
William 145

HOWATT,
Mary (WIGHTMAN) #2

HOWSON,
Ann (MILLER) #84

HUNTER,
Elizabeth (JOHNSTON) #54
Freda G. (SCOTT) 106

IMAY,
Alice M. (PROCTOR) #102

JACKSON,
Frances Mary (MONTGOMERY) 321
William 36

JACOBS,
Rebecca (BRETZ) #93

JAMIESON,
Agnes (STONEHOUSE) #288

Index Brandon Cemetery

- JOHNSON,
 Annie #207
 Annie M. 309
 Charlotte M. #309
 Charlotte (COLTON) 309
 Henry 309
 Hester L. (BRADBURN) 298
 Josephine (BRYDGES) 297
 Maitland 207
 Margaret (GOLLEY) 309
 William 309
- JOHNSTON,
 Annie M. (GEDDES) #207
 Charles 207, 295
 David 77
 Elizabeth (BRYDGES) 52
 Elizabeth (HUNTER) 54
 Mabel 207
 Maitland 207?
 Martha (GRIGG) 77
 Mary Jane (SHOEBOTTOM) 54
 Sarah J. 77
 Susannah 77
 William 54
 Ethel (MAXWELL) 95
- JORDAN,
 George A. #138
 Mabel M. (WALSH) 138
 Martha (DAVIDSON) 270
 Samuel 270
 Wm. J. 270
- JOYCE,
 Elizabeth (MacLEAN) #123
- KARNEY,
 Jane (LITTLE) #199
- KAUFMAN,
 Pauline #216
- KEATING,
 Annie (EDWARDS) #250
 Cela E. (COULTES) 172
 Charles J. 250
 Norman E. 172
- KELLEY,
 Estella (COOK) #314
 James, Pte 314
- KELLY,
 Clifford A. #101
 Jean (ANDERSON) 101
 William 101
- KERNEY,
 Elizabeth A. (FORBES) #128
- KERR,
 Jane (McKIBBON) #141
 KERRY, - Grace M. (COULTES) #22
- KINZIE,
 Rosetta (GOOD) #113
- KIRKBY,
 Annie B. (SCOTT) #227
 Harry 227
- LAKE,
 Mary Emma (HOPPER) #260
- LAMONT,
 Daniel Walton #302
 James Kennedy 302
 Margaret Irene (SMITH) 302
- LAWLOR,
 Jane Ann (BRANDON) #94
- LAWRENCE,
 Caroline (WHEELER) #192
 Charles W. 271
 Susanna (SHERRY) 271
 William W. 271
 *Winona (STONEHOUSE) 288
- **LEDIET,
 Corinne M. (McLEAN) #167
 *Bill 167
- LEAVER,
 Annie A. (COULTES) #169
 Jennie (COULTES) 63
- LEITCH,
 James #111
 John A. 111, 112
 Lily M. (HENDERSON) 111
- LIDDIARD,
 Dorcas (McCORKINDALE) #81
- LIND,
 Agnes E. (BRANDON) #238
 Babe 238
 *James H. 238
- LITTLE,
 Jane (KARNEY) #199
 *William 199

Index Brandon Cemetery

LITTLEFAIR,
Ann (WILKINSON) #228

LOGAN,
Clifford #301
Dorothy (VINCENT) 301

LOVE,
Mary Ellen (VINT) #117
William 117

MacASH,
Eleanor (ARMSTRONG) #83
Eleanor J. (WARK) 83
John 83
John A. 83

MacLEAN,
Elizabeth (JOYCE) #123
Hugh 123.

MacSWEEN,
#303

MAKAS,
Mary Ann (WHEELER) #65
Vincent 65

MARSHALL,
Jane (ANDERSON) #157

MASON,
Edna (YOUNG) #131
Edwin J. 133
Ethel (CLARK) 280
John 280
John W. 133
Margaret E. (NICOL) #133

MAXWELL,
Annie (WILSON) #95
Ellen 95
Ellen (McELROY) 204
Ethel (JOHNSON) 95
Garrett 204
John 204
Johnston 95
Thomas 95

McBURNEY,
Alexander #217
Frederick P 218A
J. Allan 105
John C. 261
Lauretta 217
Marion W. (WHITE) 105
Mary (MORTON) 118
Robena M. (YOUNG) 261

McCALLUM,
Agnes (DUNBAR) #265
Edith M. (BRUCE) 110
Esther B. (BRUCE) 104
Isabella 47
James 40
Jas. 40
John E. 110
John F. 104
John Wendell 106
Sarah (BRYDGES) 148
Sarah (McLEAN) 40

McCLELLAND,
Alex #160
Charles 160
James 160
J. Chas. 160
Margaret A. 160
Matilda 160
Matilda (SPENCE) 160

McCORKINDALE,
Dorcas (LIDDIARD) #81
Robert 81

McCORMICK,
Isabell (YOUNG) #267

McCREA,
Cornelius G. #97
Eliza (BRYDGES) 28
Frances Elizabeth 212
Margaret M. 97
Matilda (WILKINSON) 208
Robert J. 208
Vera O. (BRADBURN) 97

Index Brandon Cemetery

McCURDY,
 Elizabeth (FERGUSON) #191

McDOUGALL,
 Isabella (CEASOR) #45

McDOWELL,
 Harvey #43
 Maude (CAMPBELL) 43

McELROY,
 Ellen (MAXWELL) #204

McGILL,
 Cora M. (WILLIAMSON) #209
 Eva M. (DICKSON) 173
 John 209
 Joseph 173A

McGREGOR,
 Janet (SKINN) #225
 Luella (NOBLE) 256
 Roselia M. (SHIELL) 308

 Susan J. (BRUCE) 249
 William 225, 308

McGUIRE,
 Carrie M. (STONEHOUSE) #139
 Elmer, Pte 247
 Harry L. 139
 Mary Ann (SOWLER) 247
 W. John 247

McKENZIE,
 Ann (COLE) #29
 Helen C. (STEWART) 312
 H. Louise (GEIGER) 312
 Jack 312
 Jane 8
 Jennie (ARMSTRONG) 277
 Peter 8
 Phillip 8
 Robert E. 312

McKIBBON,
 Andrew #141
 Jane (KERR) 141

McKIENZIE,
 Isabella (GEDDES) #268

McLEAN,
 Annie #124
 Annie Pearl 188
 Chesley 188
 Colin H. 124
 Corinne M. (LEDIET) 167
 Ida J. (RINTOUL) 167
 John 188
 Lillian B. (BROOKS) 210
 Margaret (SHEFFIELD) 188
 Mary (GEDDES) 146
 Netty E. 124
 Percy D. 167
 Sarah (McCALLUM) 40..

McMICHAEL,
 Elizabeth (MONTGOMERY) #321

McMURRAY,
 Margaret (PROCTOR) #73
 Mary Ann (WALSH) 211
 Mary (YUILL) 44
 Robert 44
 William 211

McNALL,
 Julia E. #300

McPHEE,
 Barbara J. (VanNORMAN) #235

McSWEEN,
 Edna M. (VINCENT) #303
 George R. 303

MILLER,
 Ann (HOWSON) #84
 Catherine (PROCTOR) 32
 Elizabeth (VanNORMAN) 232
 Ellen (COULTES) 78
 Isabella (HALL) 159
 Margaret D. (GALLAGHER) 53
 Miles 84
 Robt. 159
 Sarah J. (BRECKENRIDGE) 179
 William 84

MITCHELL,
 A. J. (CLOWES) #121

Index Brandon Cemetery

MONTGOMERY,

Bertha #321
 Elizabeth (McMICHAEL) 321
 Frances Mary (JACKSON) 321
 Lizzie Pearl 321
 Maggie Sarah 321
 Thomas M. 321
 Lloyd 321

MORTON,

Alexander #118
 Mary (McBURNEY) 118

MOY,

Eric #284

MUNRO,

Finlay #8

NAYLOR,

Ann (TAYLOR) #140
 Elizabeth M. (PROCTOR) 72
 Julia Ann (ANDERSON) 79
 Fountain 140

NESBIT,

Mary I. (GRASBY) #156

NETHERY,

Aita K. (HAMILTON) #178
 George E. 130
 Gordon 66
 Grace (YULE) 66
 Herman 178
 Isabella (WIGHTMAN) 150
 J. Cooper 129
 John 130
 Maggie L. (NICHOL) 153
 Martha J. 130
 Mary A. (OWENS) 56
 Mary E. (HENDERSON) 130
 Mary Fern (HEDLEY) 137
 *Mary R. (WADE) 168
 Ruth E. 130
 Stella J. 174

NEWCOMBE,

Susan (WILKINSON) #119

NEWMAN,

Doris G.E. (ARMSTRONG) #313

NICHOL,

Annie Olive (WALTERS) #153
 James B. 153
 James Budge 153
 James Ellwood 153
 Maggie L. (NETHERY) 153
 Margaret E. (MASON) 133

NICHOLSON,

Agnes #276
 Alice (BIRCHILL) 34
 Alice M. (OSBOURNE) 276
 *Archibald 34
 *Chas. F. 239
 Elizabeth W. 239
 James 276
 Mary A. 35
 *Robert 35
 W. Garner 276
 William C. 34
 William Charles 34

NIXON,

Alice (STONEHOUSE) #287
 Joseph 287
 *T. E. 287

NOBLE,

Luella (McGREGOR) #256
 Roy 256

OAK,

Mary (BONE) #244

ORR,

Sarah (SCANDRETT) #275

OSBOURNE,

Alice M. (NICHOLSON) #276

OTTO,

Dorothea (SCHAAF) #20
 Heinrich 20

OWENS,

Mary A. (NETHERY) #56
 Robert 56

Index Brandon Cemetery

PARAN,
 Mary #243

PARKERSON,
 Lena (STUBBS) #206

PARKHILL,
 Lily (FERGUSON) #194

PATTERSON,
 Elizabeth #92

PEAREN,
 Charlotte (BENGOUGH) #200
 Henry I. 200
 Mary A. 201
 Matthew 201
 Mina, E. 200

PENGELLY,
 *Gordon #216
 Marilyn J. (CAMPBELL) 220
 Pauline (KAUFMAN) 216

PERDUE,
 Mildred (VANNON) #214

PICKELL,
 Brian James #229
 *Velma 229
 *Wilfred 229

PORTERFIELD,
 Alex #114
 Mary (GEDDES) 23
 Mary (STEVENSON) 203
 Maud (CODE) 114
 Peter, Jr. 203
 Peter, Sr. 203

PRIER,
 Margaret J. (HOPPER) #145

PROCTOR,
 Abraham #5, 50, 71
 A. Harold 70
 Alice M. (IMLAY) 102
 Catherine (MILLER) 32
 Charles 198
 Charles Andrew 26
 Dorothy H. (STAPLETON) 171
 Edith E. 99
 Edna P. (HENDERSON) 68
 Eliza 73
 Elizabeth 67, 198
 Elizabeth N. (NAYLOR) 72
 Elizabeth (SPEAKMAN) 67
 Eliza J. (SCANDRETT) 74
 Ellen M. (HOPPER) 49
 Ellen (WILKINSON) 99
 Elva M. (BROOKS) 26
 Florence A. (HIGGINS) 173
 George 32
 George W. 99
 Grace (CURTIS) 70
 Hazel H. (WILKINSON) 49
 James 189
 J. Carl 49
 John 190
 J. Stewart 102
 Leeland 222
 Louisa Jane (BARR) 189
 Mable (YUILL) 135
 Margaret (CAMPBELL) 224
 Margaret (McMURRAY) 73
 Mary A. (BROWNRIDGE) 50, 51
 Mary A. (STEWART) 71
 Mary E. 49
 M. Verda (ARMSTRONG) 69
 Pearl Ann (WHEELER) 59
 Rebecca (BRANDON) 231
 Richard 73
 Richard W. 68
 Robert C. 67
 Rowland A. 33
 Thomas 231
 W. Charles 49
 Wilbert R. 171
 William 49
 *William J. 72

 Wilm J. 50
 Wm. 31

Index Brandon Cemetery

RATH,
Elizabeth (STONEHOUSE) #273

RENNIE,
Margaret (WIGHTMAN) #80

REZANSOFF,
Mike #136
Myrtle A. (YUILL) 136

RINN,
Harry #109
May 109

RINTOUL,
Ida J. (McLEAN) #167

ROBERTSON,
Catherine (HALLIDAY) #55
M. Ruby (TAYLOR) 170

ROBINSON,
Laura M. (WHEELER) #132

ROGER,
John Stewart #62

RUDDY,
Joseph D. #279
Margaret R. (BRYDGES) 279

RUSSELL,
Chrisrie (STONEHOUSE) #273
T. M. 273

RUTHERFORD,
Mary #293
Smith 293

SACKRIDER,
Alma (SCOTT) #248

**SAUNDERS,
Lottie Margaret (SCOTT) #100

SARGEANT,
Frances L. #213

SAVAGE,
Charlotte S. (GARNISS) #262

SCHAAF,
Dorothea (OTTO) #20
Henry 19

SCANDRETT,
Corine #116
Edna May (WHEELER) 132
Eliza (PROCTOR) 74
John 275
Julia Ann (ANDERSON) 116
Lily M. (COLE) 281
Robert Percy 116
Sarah (ORR) 275
Thomas 74

SCOTT,
Alexander #286
Alice E. (HARRISON) #263
Alice L. (SHACKLETON) 305
Allan R. 147
Alma (SACKRIDER) 248
Annie 248
Annie B. (KIRKBY) 227
Annie H.B. (FELLS) 266
Annie M. 37
Cyrus W. 57
David 6
David S. 5
Donald M. 107
Elizabeth A. (HARRISON) 227
Elizabeth (DALGARNO) 147
Elizabeth (ELLIOT) 6
Florence M. 21
Freda G. (HUNTER) 107
Grace (DELGARNO) 147
Grace Elizabeth (BRUCE) 205
Grace (TAYLOR) 286
James A. 147
Jane (WALSH) 5
Jennie 286
John Kenneth 100
John S. 263
John T. 147
Lizzie (CUNNINGHAM) 57
Lottie Margaret (SAUNDERS)
100
M. Agnes 147
Malcolm R. 107
Margaret I. (AITKEN) 100
Martha (COULTES) 197
Mary Ann 147
Mary E. 147
Peter W. 37
Robert 147
Robert J. 100
Violet M. (WIGHTMAN) 108
Walter H. 305
Walter S. 147
William 147
William C. 227
William E. 248
W. J. Bordon "Bud" 108

**out of order

Index Brandon Cemetery

SHACKLETON,
Alice L. (SCOTT) #305

SHARP,
Ann #121

SHARPE,
James #185
Margaret 125
*Mary J. 184
William 184
*Wm. 184

SHARPIN,
Jean (HOPPER) #304

SHEFFIELD,
Margaret (McLEAN) #188

SHERRY,
Susanna (LAWRENCE) #271

SHIELL,
Roselia M. (McGREGOR) #308

SHOEBOTTOM, Esther N. (BRYDGES) 161
John Francis #54
Mary Jane (JOHNSTON) 54
Thomas 161

SKINN,
Janet (McGREGOR) #225

SMITH,
Margaret (LAMONT) 302
Marion Isabel (WIGHTMAN) 115
Mary (RUTHERFORD)? 293
Rutherford 293
Thomas 299

SOWLER,
Horace W. #247
Lelah 247
Mary Ann (McGUIRE) 247

SPEAKMAN,
*Elizabeth (PROCTOR) #67

SPEIR,
Margaret M. (WALSH) #103

SPENCE,
Matilda (McCLELLAND) #160

SPROAT,
Mary J. (ANDERSON) #285

STAPLETON,
Dorothy H. (PROCTOR) #171

STEVENSON,
Mary (PORTERFIELD) #203

STEWART,
Alexander #195
Elen S. 195
Helen C. (McKENZIE) 312
*James 317
*John 195
Mary A. (PROCTOR) 71
Mary A. (WILLIAMSON) 317
Mary E. (WALSH) 195

STOKES,
M. Olive (BOLT) #175

STONEHOUSE,
Agnes (JAMIESON) #288
Alice (NIXON) 287
*Annie B. 272
Carrie M. (McGUIRE) 139
Chrisrie (RUSSELL) 273
Elizabeth (RATH) 273
Frances (HOPPER) 226
Gordon, M.D. 288
John 272
Lorne C. 273
Marshall 258
Mary Ellen (COULTES) 182
Myrtle (HENRY) 258
Norman 257
Richard 273
Stewart 288
*Violet E. (BLACKWELL) 257
W. H. 272
*Winona (LAWRENCE) 288
Robert M. 288

STUART,
Agnes B. (BENGOUGH) #187

Index Brandon Cemetery

STUBBS,

Francis E. #89
 Francis Sarah (CHARLTON) 206
 Joseph 89
 Joseph E. 88
 Lena (PARKINSON) 206
 Mary Jane 89
 William Snell 206

SWINDLEHURST,

Maggie #35

TASKER,

James A. #38
 Mary J. (CAMPBELL) 38

TAYLOR,

Agnes (BELL) #158
 Ann #140
 Elizabeth (PATTERSON) 92
 Grace (SCOTT) 286
 Hazel Dell (VanCAMP) 176
 Infant Dau. 158
 James 246

Jennie Isabella 246
 John 158
 M. Ruby (ROBERTSON) 170
 Orval E. 170
 Robert 92
 Robert A. 92

TURVEY,

Mary (COULTES) #27

TYNDALL,

Alice A. #78

VanCAMP,

Bertha Rose (HANEY) #166
 Hazel Dell (TAYLOR) 176
 James H. 166
 William G. 176

VANNAN,

Lawrence #214
 Mildred (PERDUE) 214

VanNORMAN,

Barbara J. (McPHEE) #235
 Charles Simon 223
 Elizabeth (MILLER) 232
 Isabella E. (HOPPER) 320
 Josephine (FINDLATER) 233
 Mary Jean (DOLL) 223
 Robert 235
 Simon 232

VARDON,

A. Lorraine (GEDDES) #24

VINCENT,

Dorothy (LOGAN) #301
 Edna M. (McSWEEN) 303

VINT,

Mary Ellen (LOVE) #117

WADE,

Clarence H. #168
 *Mary R. (NETHERY) 168

WALSH,

Gordon E. #103
 Isabel 76
 James T. 255
 Jennie M. 255
 Joshua I. 12
 Mabel M. (JORDAN) 138
 Margaret (ANDERSON) 274
 Margaret (BELL) 12
 Margaret M. (SPEIR) 103
 Mary Ann (McMURRAY) 211
 Mary E. (STEWART) 195
 Mary Jane (WILKINSON) 228
 Samuel I. 274
 Susannah (BELL) 230
 Thomas M. 230
 Thos. 76
 Jane (SCOTT) 5

WALTERS,

Annie Olive (NICHOL) #153

WARK,

Eleanor J. (McASH) #83

Index Brandon Cemetery

WATSON,

Mary Ellen (GEDDES) #196
 William 196
 Willie A. 196

WEATHERAL,

Crooks #315
 Charlotte 315

WHALEY,

Ellen E. (WILKINSON) #152
 William K. 152

WHEELS,

Jean (BRYDGES) #120

WHEELER,

Caroline Lawrence #192
 Charles 192, 229
 Daniel 245
 Edna May (SCANDRETT) 132
 Eliza 229, 245
 G. Goldwin 64
 Hazel B. (CAMPBELL) 251
 Herbert 59
 Ivan 65
 Jesse 251
 Kenneth 65
 Laura M. (ROBINSON) 132
 Mable I. (COULTES) 65
 Mary Ann (MAKAS) 65
 Mary Ann (WILKINSON) 229
 Myrtle A. (ANDERSON) 306
 Pearl Ann (PROCTOR) 59
 Selena (HIGGINS) 215
 Winnifred 64
 Cecil W. 132

WHITE,

Marion W. (McBURNEY) #105

WIGHTMAN, #41

Albert E. #163
 Catherine 80
 Charles H. 2
 Charles Ivan, Pte 2
 Douglas Smith 115
 *Edwin 163
 George D. 115
 Grace A. 163
 Isabella (NETHERY) 150
 J. C. R. 291
 J. Edgar 307
 James 42, 80
 John 150, 163
 J. Viola (CAMPBELL) 42

WIGHTMAN,

Margaret (BLACK) #86
 Margaret (RENNIE) 80
 Marion Isabel (SMITH) 115
 Mary H. (BLACK) 219
 Mary (HOWATT) 2
 Robert 150
 *Sarah 163
 Thomas 163
 Violet M. (SCOTT) 108
 Winnifred 307

WILKINSON,

Ann (LITTLEFAIR) #228
 C. B. 228
 Charles 11
 Elizabeth J. (ANDERSON) 278
 Ellen E. (WHALEY) 152
 Ellen (PROCTOR) 99
 Harry 11
 Hazel H. 49
 James 149
 Jane (DODDS) 149
 Joseph 143
 Margaret (CLARKE) 11
 Mary Ann (WHEELER) 229
 Mary Jane (WALSH) 228

 Matilda (McCREA) 208
 Susan (NEWCOMBE) 119
 Thomas 119
 W. B. 228

WILLIAMSON,

Cora M. (McGILL) #209
 James 316
 Mary A. (STEWART) 317
 Mary J. (FERGUSON) 316

WILSON,

Annie (MAXWELL) #95
 *James 95
 *I. 241
 M. W. (GEDDES) 241

Index Brandon Cemetery

WRAY,

Benjamin #91
Dora A. (BRANDON) 98
Elizabeth 91
Mary Ann (DALEY) 10
Sarah E. (CROWE) 90
William 90

YOUNG,

Agnes #131
Alexander Forrest 165
Archie 131
Edna (MASON) 131
Elmer 131
Isabell (McCORMICK) 267
James F. 267

Robert J. 131
Robena M. (McBURNEY) 261

YUILL,

Elizabeth (BOYD) #154
Joseph 135
Mabel (PROCTOR) 135
Margaret 134
Mary (McMURRAY) 44
Myrtle A. (REZANSOFF) 136
Robert 154
Robert G. 135

YULE,

Grace (NETHERY) #66

Cemeteries of East and West Wawanosh Townships, Huron County

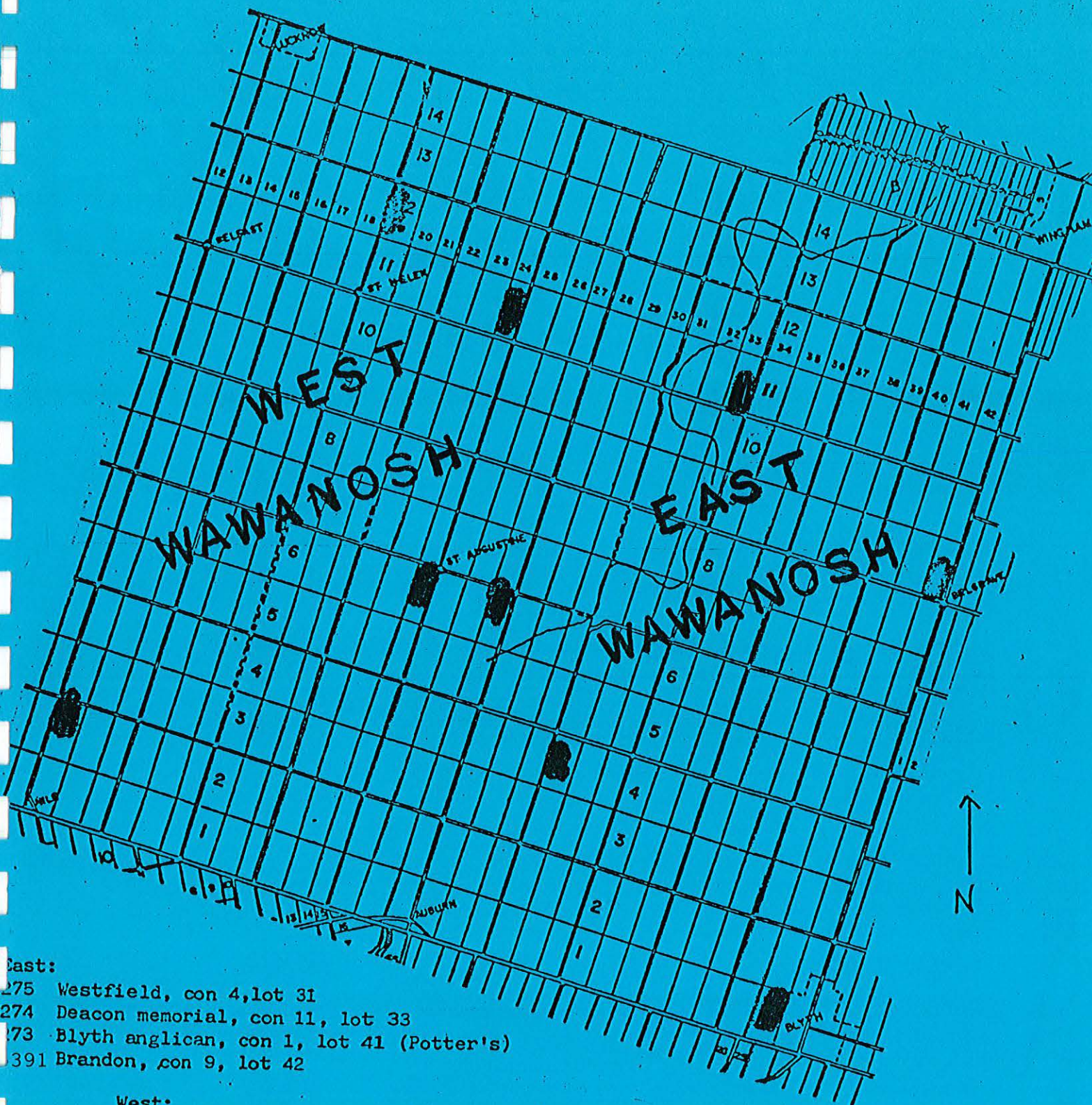

- East:
- 3275 Westfield, con 4, lot 31
 - 3274 Deacon memorial, con 11, lot 33
 - 3273 Blyth anglican, con 1, lot 41 (Potter's)
 - 3291 Brandon, con 9, lot 42

- West:
- 3277 Memorial cairn, con 2, lot 13
 - 3278 Bethel, con 11, lot 24
 - 3280 St. Augustine R.C., con 6, lot 24
 - 3281 St. Helen's, con 12, lot 19
 - 3279 Donneybrook United, con 6, lot 27